

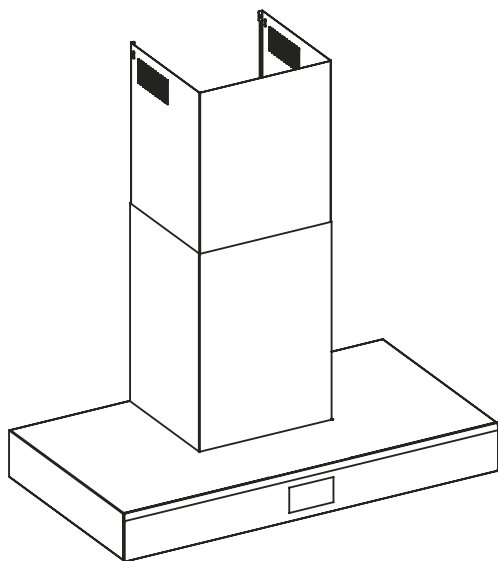







90CM T-SHAPE HOOD



TFTTSCH

KARLSON
User Manual



	BEFORE USING YOUR APPLIANCE	03
	SAFETY	03
	ELECTRICAL INSTALLATION	05
	TECHNICAL DATA	06
	TROUBLESHOOTING	08
	GUARANTEE	09
	WHAT'S REQUIRED FOR INSTALLATION	12
	WHAT'S IN THE BOX	12
	INSTALLATION	13
	USE	20
	FUNCTIONS & SETTINGS	20
	CONNECTIVITY	29
	CARE & MAINTENANCE	38
	SERVICE & SPARES	40



BEFORE USING YOUR APPLIANCE

These instructions are for your safety. Please read the following instructions carefully before proceeding with the installation and use of this appliance.

WARNING: All installation work must be carried out by a suitably qualified person, strictly following local building regulations and these instructions.

- To avoid the risks that are always present when you use an electrical appliance it is important that this cooker hood is installed correctly and that you read the safety instructions carefully to avoid misuse and hazards. After unpacking the cooker hood please check that it is not damaged. If in doubt, do not use the appliance but contact Customer Services.
- Check the package and make sure you have all of the parts listed and decide upon the appropriate location for your product. If this product contains glass please take care with fitting or handling to prevent personal injury or damage to the product. The specification plate shown on this appliance displays all the necessary identification information for ordering replacement parts. If you sell the appliance, give it away, or leave it behind when you move house, please ensure that you pass on this manual so that the new owner can become familiar with the appliance and its safety warnings.

SAFETY

You must comply with existing legislation on emission of fumes and environmental ventilation. Do not connect the hood to another vent for smoke, ventilation or hot air which is already being used by other appliances that are fuelled by gas or another fuel.

Before connecting the hood, shut off the power supply and check that the voltage and frequency supply matches that indicated on the rating plate of the equipment.

To avoid the risk of fire, the metal filter should be cleaned regularly.

Containers with hot oil should be monitored continuously.

Do not set food alight under the hood.

Accessible parts may become hot when used with cooking appliances.

For optimal and safe performance, the pressure in the room should not drop by more than 4 Pa (0.04 mbar). For this purpose, sufficient permanent air inlets should be provided to prevent the premises from being sealed.

continued overleaf



GENERAL SAFETY

If a kitchen extractor hood and appliances fuelled by gas or another fuel are used simultaneously, there must be an appropriate ventilation system in the room.

The hood may stop working during an electrostatic discharge (e.g. lightning). This involves no risk of damage. Switch off the electricity supply to the hood and reconnect after one minute.

This hood can be used by children aged from 8 years and above and persons with reduced physical, sensory or mental capabilities or lack of experience and knowledge if they have been given supervision or instruction concerning use of the appliance in a safe way and understand the hazards involved. Children shall not play with the hood. Cleaning and user maintenance shall not be made by children without supervision. Keep the hood and its supply cord out of the reach of children less than 8 years old.

- Do not use flammable sprays in close vicinity to the appliance.
- If the supply cord is damaged, it must be replaced by the manufacturer, its service agent or similarly qualified persons in order to avoid a safety hazard.
- Please dispose of the packing material carefully. There is a fire risk if cleaning is not carried out in accordance with the instructions. Refer to the Care and Maintenance section carefully for details on how to clean and replace the aluminium and carbon filters (if fitted).
- The LED lamps in this appliance are not replaceable by the consumer. If a lamp fails, please contact the customer helpline at the end of Care & Maintenance section to arrange an engineer visit.
- Do not use a steam cleaner for care and maintenance.
- There shall be adequate ventilation of the room when the hood is used at the same time as appliances burning gas or other fuels. Ensure that the negative pressure of the installation site does not exceed 4 Pa (0.04 mbar) to ensure combustion fumes are not drawn back into the room. Regulations regarding air extraction must be complied with.
- Adapters, multi-way strips and extension leads must not be used. Overloading can result in a risk of fire.
- Do not use the hood if it shows signs of damage or imperfection. Contact customer services for assistance.
- The manufacturer declines all liability for personal or material damage as a result of misuse or incorrect installation of this appliance.
- The appliance is intended for domestic use only.



ELECTRICAL INSTALLATION

All installation must be carried out by a competent person or qualified electrician. Before connecting the mains supply ensure that the mains voltage corresponds to the voltage on the rating plate.

Direct Connection

The appliance must be connected directly to the mains using an omnipolar circuit breaker with a minimum opening of 3mm between the contacts. Alternatively this appliance can be fitted with a 3 pin (UK) plug.

The installer must ensure that the correct electrical connection has been made and that it complies with the wiring diagram.

The cable must not be bent or compressed.



WARNING: This is a Class I appliance and MUST be earthed.

This appliance is supplied with a 3 core mains cable coloured as follows:

Brown = L or Live

Blue = N or Neutral

Green and Yellow = E or Earth 

To avoid the risks that are always present when you use an electrical appliance it is important that this appliance is installed correctly and that you read the safety instructions carefully to avoid misuse and hazards. Please keep this instruction booklet for future reference and pass it on to any future owners. After unpacking the appliance please check that it is not damaged. If in doubt, do not use the appliance but contact Customer Services.

The manufacturer declines all liability for damage caused to persons and objects due to incorrect or improper installation of the appliance. Any permanent electrical installation must comply with the latest wiring regulations applicable to your country and for your own safety a qualified electrician or contractor should undertake the electrical installation.

The appliance is supplied from the factory to use external ducting (not supplied). Should you wish to use this in recirculation mode only, please fit the correct carbon filter (not supplied).

Switched Fused Spur Outlet

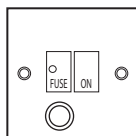

USE A 3AMP FUSE

**TECHNICAL DATA**

Supply voltage	220-240V~ 50Hz
Power consumption - Motor	135W
Power consumption - Cooking Light	1 x 5W Max
Power consumption - Total	138W
Protection class	I
ILCOSD Code - Cooking Light	DSL-5-S-765/24/20
Frequency band	434 MHz

Information for EU No. 66/2014 and No. 65/2014 A. Information of the cooker hood.

**TECHNICAL DATA**

Trademark	Value
Model identification	TFTTSCH
Annual Energy Consumption (AEC hood) (kWh/year)	21.3
Energy Efficiency class	A++
Fluid Dynamic Efficiency	39.3
Fluid Dynamic Efficiency class	A
Lighting Efficiency (LEhood) (lux/W)	14.8
Lighting Efficiency class	D
Grease Filtering Efficiency (GFE hood)	58.6
Grease Filtering Efficiency class (GFEhood)	E
Minimum air flow at working point (in normal use) (m ³ /h)	270.8
Maximum air flow at working point (in normal use) (m ³ /h)	608.5
Maximum air flow at highest setting (Q _{max}) (m ³ /h) (with Boost)	851.6
Weighted sound power level at minimum setting (LWA) (dB)	46
Weighted sound power level at maximum setting (LWA) (dB)	65
Sound power level of boost if any (LWA) (dB)	70
Measured power consumption off mode (P _o) (W)	0.46
Measured power consumption in standby mode (P _s) (W)	0
Time increase factor (f)	0.6
Energy Efficiency Index (EEIhood)	34.2
Measured air flow rate at best efficiency point (QBEP) (m ³ /h)	369.4
Measured air pressure at best efficiency point (PBEP) (Pa)	308
Measured electric power input at best efficiency point (WBEP) (W)	80.5
Nominal power of the lighting system (WL) (W)	5
Average illumination of the lighting system on the cooking surface (E _{middle}) (lux)	74

**TROUBLESHOOTING**

IMPORTANT: If your hood appears not to be operating properly, before contacting Customer Services, please refer to the checklist below.

Problem	Possible Cause/Solution
The lamps do not work.	A change may be necessary, but first check that the lamp is correctly positioned and that the contact is correct. Remember that lamps are not covered by the warranty. PLEASE CONTACT CUSTOMER SERVICES.
The motor works, but it seems to have requested performance or extraction capacity.	<ol style="list-style-type: none">1. The selected speed is too low. Select a higher speed.2. Check the Metallic Filter (grease filter) - if it has not been washed recently, it may be clogged with grease or dirt. Disassemble and wash it in hot water and detergent, and let it dry before reassembling again.3. Ensure that the air outlet tube has not been obstructed.
The hood works, but the smell of the food persists.	If you are using the hood in recirculation mode, the Active Carbon Filter must be replaced.
The hood does not work.	Check that the hood is connected to power. Check that the fuses or automatic have not jumped.
The hood still does not work.	Fit carbon filter or replace the carbon filter (see Care and Maintenance section).



DECLARATION OF CONFORMITY

(EU) Declaration of Conformity

Name and address of the manufacturer or his authorised representative:

AAUK Ltd

Unit 3 Normandy Landings

Pope Street, Castleford

West Yorkshire

WF6 2AG

This declaration of conformity is issued under the sole responsibility of the manufacturer.

Object of the declaration:

- **Product: 90cm T-Shape Hood**
- **Model: TFFTSC**

The object of the declaration described above is in conformity with the relevant Union harmonisation legislation:

- 2014/53/EU as amended
Radio Equipment Directive

References to the relevant harmonised standards used or references to the other technical specifications in relation to which conformity is declared:

- EN 300 220-2 V3.1.1
- EN 300 220-1 V3.1.1
- EN 301 489-1 V2.2.3
- EN 301 489-3 V2.1.1



DECLARATION OF CONFORMITY

(UK) Declaration of Conformity

Name and address of the manufacturer or his authorised representative:

AAUK Ltd

Unit 3 Normandy Landings

Pope Street, Castleford

West Yorkshire

WF6 2AG

This declaration of conformity is issued under the sole responsibility of the manufacturer.

Object of the declaration:

- **Product: 90cm T-Shape Hood**
- **Model: TFFTSCH**

The object of the declaration described above is in conformity with the relevant legislation:

- Radio Equipment Regulations 2017 as amended

References to the relevant designated standards used or references to the other technical specifications in relation to which conformity is declared:

- EN 300 220-2 V3.1.1
 - EN 300 220-1 V3.1.1
 - EN 301 489-1 V2.2.3
 - EN 301 489-3 V2.1.1
-



RECYCLING & DISPOSAL



DISPOSAL: Do not dispose this product as unsorted municipal waste. Collection of such waste separately for special treatment is necessary.

This appliance is labelled in compliance with European directive 2011/65/EU for Waste Electrical and Electronic Equipment (WEEE). By ensuring that this appliance is disposed of correctly, you will help prevent any possible damage to the environment and to human health, which might otherwise be caused if it were disposed of in the wrong way.

The symbol on the product indicates that it may not be treated as normal household waste. It should be taken to a collection point for the recycling of electrical and electronic goods.

This appliance requires specialist waste disposal. For further information regarding the treatment, recover and recycling of this product please contact your local council, your household waste disposal service, or the shop where you purchased it.

For more detailed information about treatment, recovery and recycling of this product, please contact your local city office, your household waste disposal service or the shop where you purchased the product.



WHAT'S REQUIRED FOR INSTALLATION



WHAT'S IN THE BOX

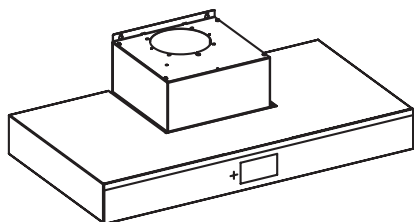

[01] x 1

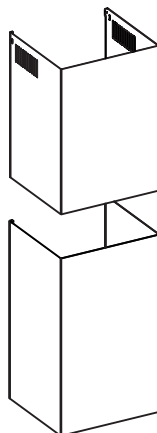

[02] x 1



[03] x 1



[04] x 1



[05] x 6



[06] x 6
4 x 32mm



[07] x 2
4 x 13mm

Not included

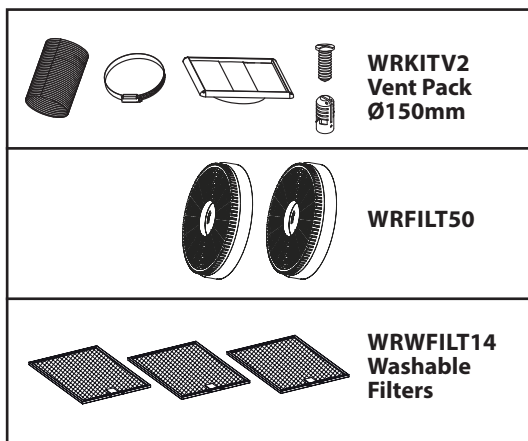



CHOOSE A TYPE OF INSTALLATION

01

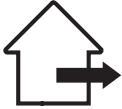

A DUCTED OPTION
(extraction to the outside)

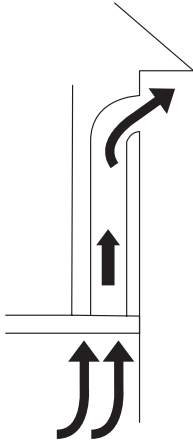

WRKITV2 Vent Pack Ø150mm

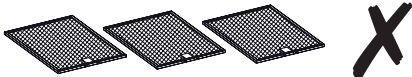
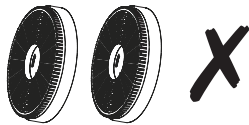

B RECIRCULATION OPTION
(no extraction to the outside).
This appliance is for installation
on a wall only.

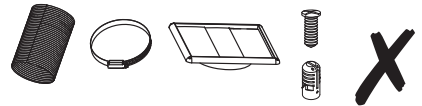
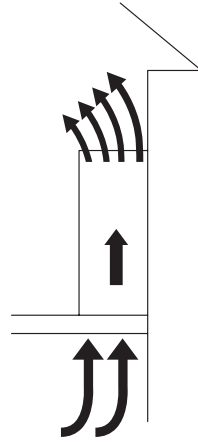

WRKITV2 Vent Pack Ø150mm

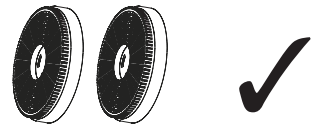

WRFIL50

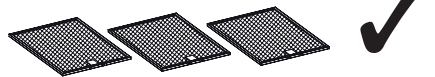

WRWFILT14



BEFORE YOU INSTALL THE HOOD

02

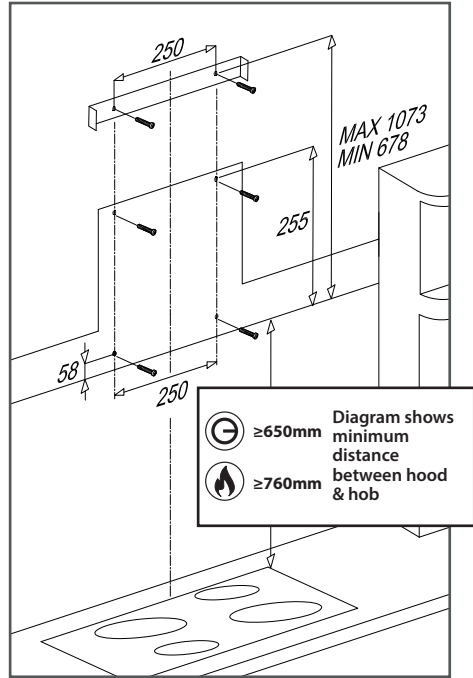
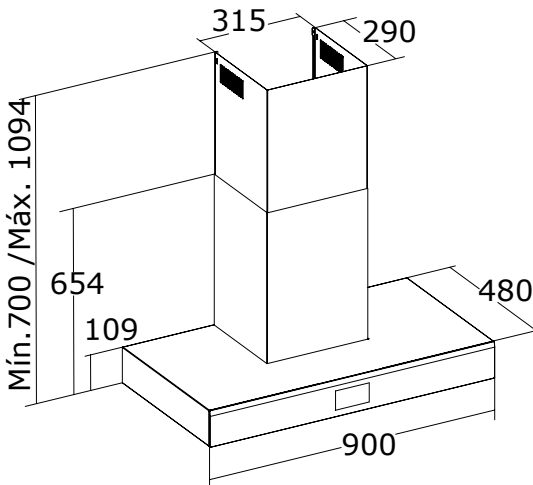

Mark the wall with the hole positions as shown in the diagram. The fixings supplied are suitable for solid walls only. When fixing to any other type of wall use suitable alternative fixings.

Drill the holes, insert the wall plugs in all 6 holes. Insert the screws in the holes in the second row from the bottom. The gap between row two and row three from the bottom should be between 420-820mm, dependent upon the ceiling height.

Caution! Before drilling it is extremely important to check the wall for hidden pipes, electrical cables etc using an appropriate detection device.

Use only the same size of fittings and mounting screws as recommended in this instruction manual. Failure to follow these instructions may result in electrical hazards.

Please follow the Safety and Electrical Installation sections at the start of this manual before connecting this appliance to the mains supply!



03



[03] x 1



[05] x 6



[06] x 6
4 x 32mm

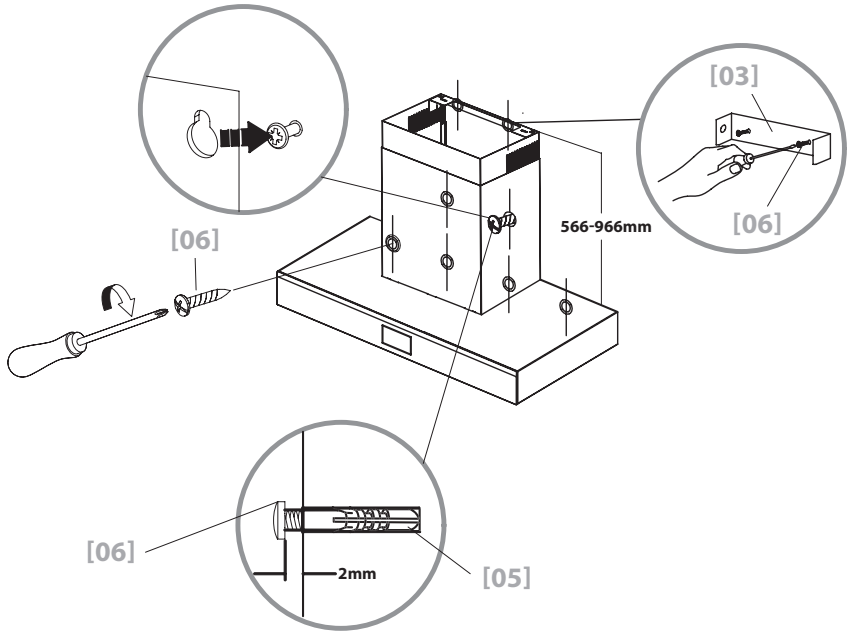

04



DUCTED OPTION
(extraction to the outside)



WRKITV2
Vent Pack
Ø150mm

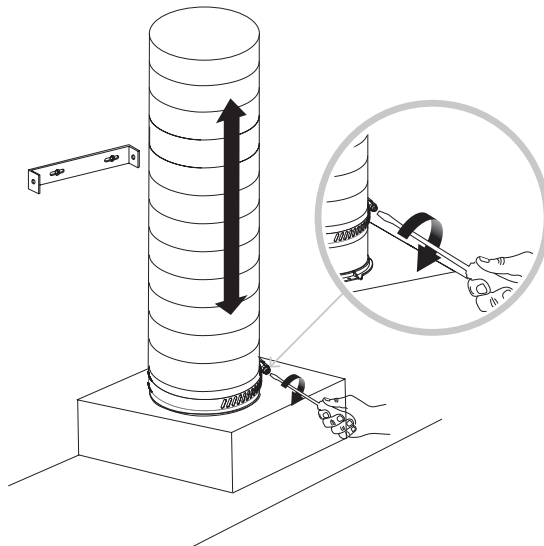



05



DUCTED OPTION
(extraction to the outside)

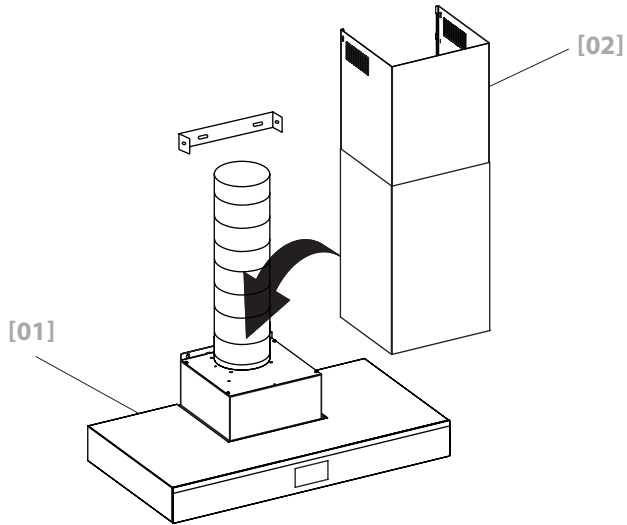
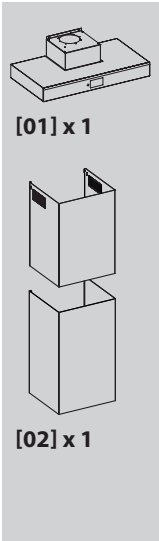



06



B RECIRCULATION OPTION
(no extraction to the outside)

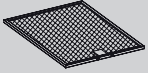

[04] x 1

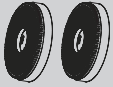

WRFIKT50

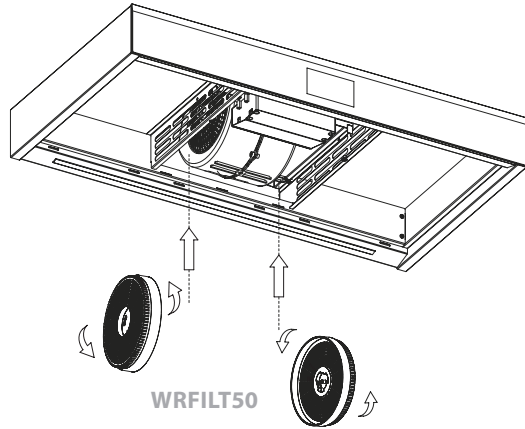
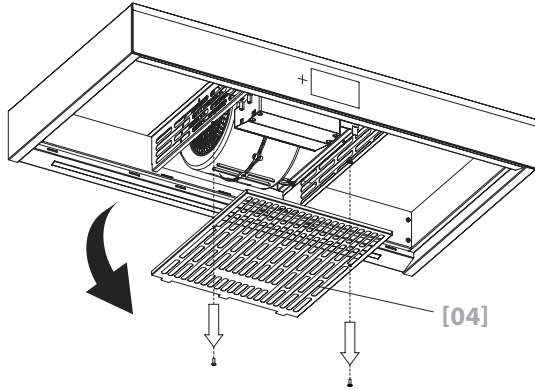

SEE STEP 7
IF REPLACING
WITH OPTIONAL
WASHABLE FILTERS

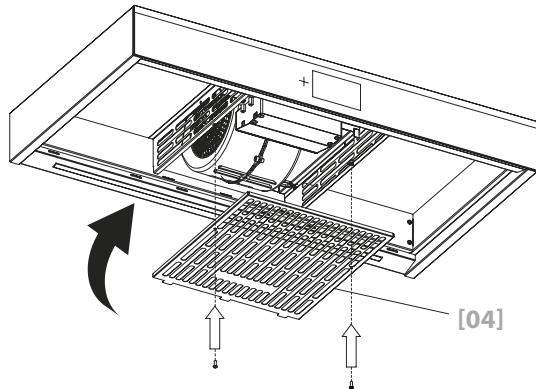



07

B RECIRCULATION OPTION
(no extraction to the outside)

USING OPTIONAL
WASHABLE FILTERS

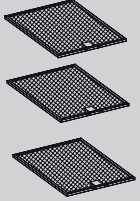

WRWFILT14
OPTIONAL
WASHABLE
FILTERS
AVAILABLE
TO PURCHASE
SEPARATELY

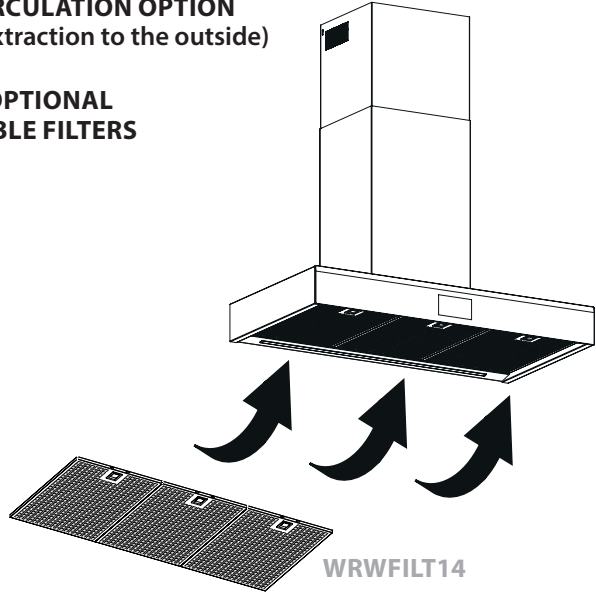

08

B RECIRCULATION OPTION
(no extraction to the outside)

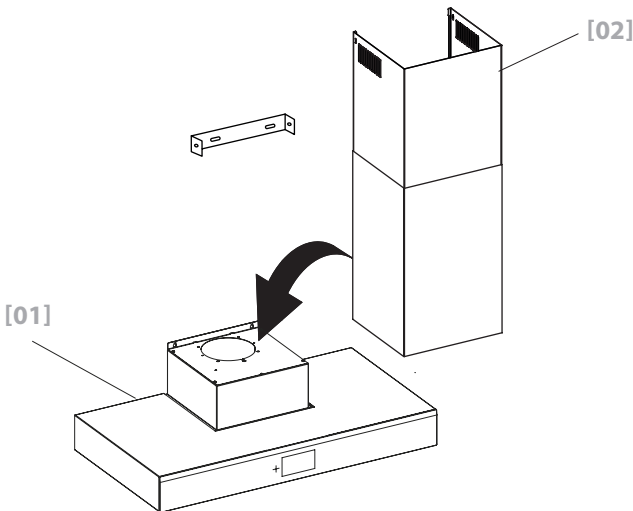



09



[07] x 2
4 x 13mm

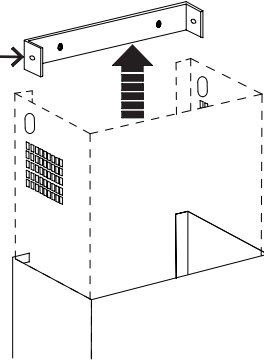
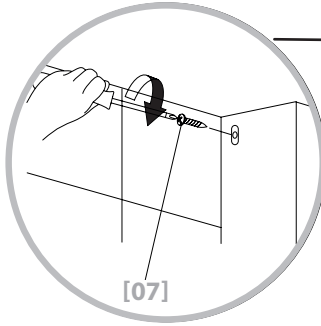

10

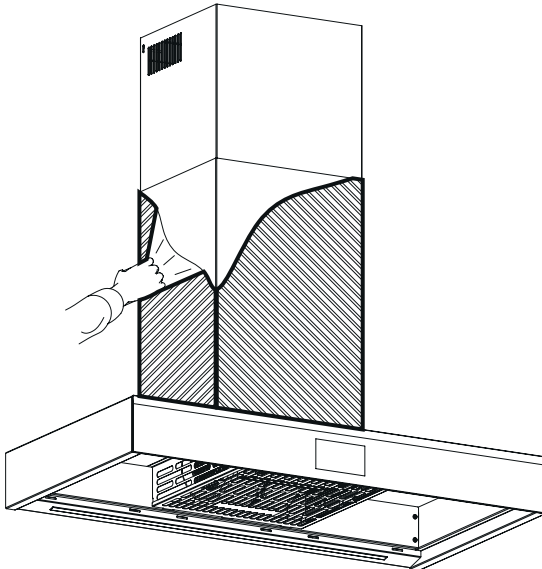



BEFORE YOU START

WARNING: Read the instructions before using the appliance.

Switch on the appliance at the switched fused connection unit. The appliance is ready for use.

FUNCTIONS & SETTINGS

01 Control panel

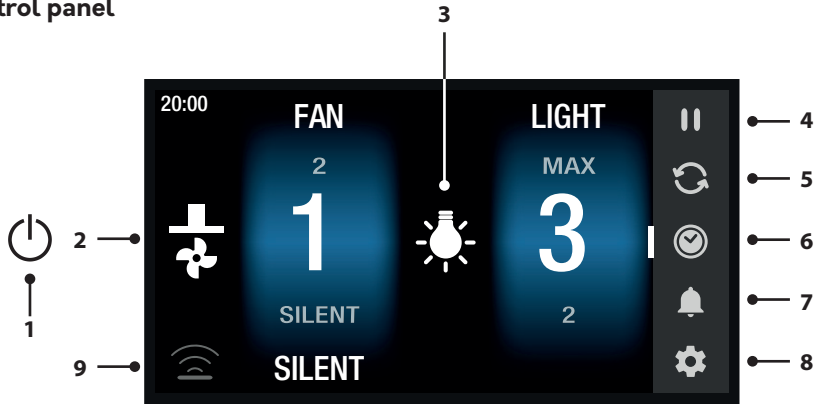

- 1. Power On/Off
- 2. Fan Control
- 3. Light Control
- 4. Pause
- 5. Air Renovation
- 6. Timer
- 7. Alarm
- 8. Settings Menu
- 9. Connectivity Key

02 Turning the hood on for the first time

When the extraction hood is connected to the mains, the screen automatically turns on.

NOTE: Any values that are not defined by the user will be set to default.

1. Set the language

Press the arrow  on the right-hand side of the screen.

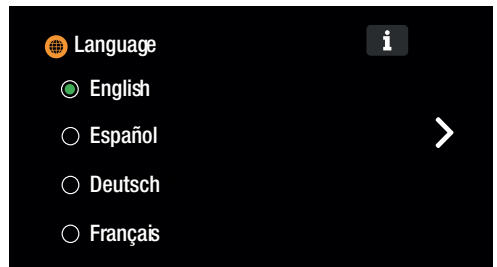



02 Turning the hood on for the first time (continued)

When the extraction hood is connected to the mains, the screen automatically turns on.

NOTE: Any values that are not defined by the user will be set to default.

2. Set the date

Press the arrow  on the right-hand side of the screen.



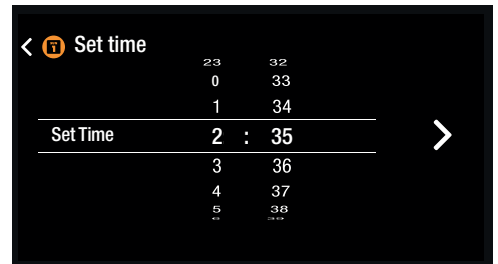

3. Set the time

Press the arrow  on the right-hand side of the screen.



4. Choose the filter

Press the  icon to select the Ducted Option (extraction to the outside)

Press the  icon to select the Recirculation Option (no extraction to the outside).

Choose between the carbon filter (supplied) or washable carbon filter (available to purchase separately).

Press the arrow  on the right-hand side of the screen to save.

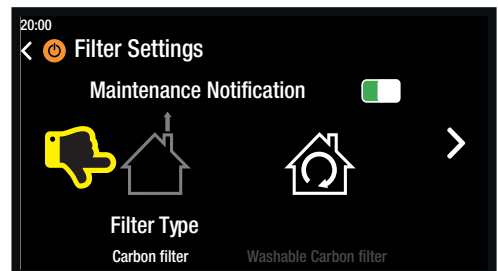
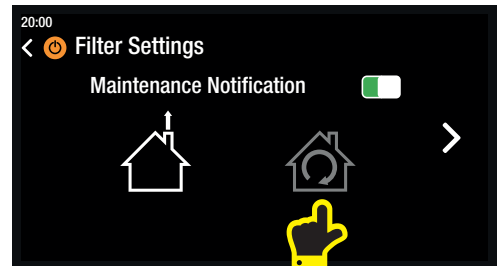



03 Operation

ON/OFF KEY

Turning the Screen On

Press the power button 

The controls for the extractor fan and the light will appear. On the right-hand side of the screen, the side menu bar will appear with various options (Pause, Air Renovation, Timer, Audible Alarm and Settings).



Turning the Hood Off

When the hood is turned on, press the power button  to turn it off.

If **Hibernation Mode** is activated, the Hibernation screen will appear.

If it is deactivated, the screen will display **Total Turn Off Time** and turn black.

The extractor fan and the light will turn off automatically.

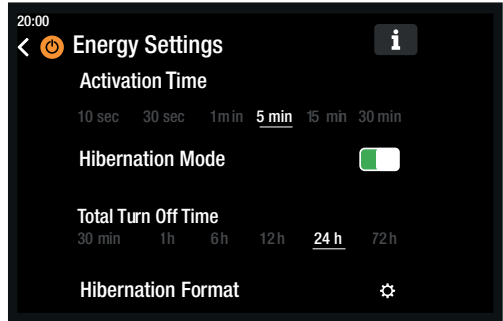

Working the Extractor Fan

1. Turn the extractor fan on by pressing  fan key.

You can adjust the desired power level (**SILENT + from 1 to 4 + TURBO**) by sliding your finger up and down.

Pressing the **SILENT/TURBO** buttons adjusts the level directly.



Working the Light

1. Turn the light on by pressing  light key.

You can adjust the desired power level (**MIN + from 1 to 3 + MAX**) by sliding your finger up and down.

Pressing the **MIN/MAX** buttons adjusts the level directly.





TIMER FUNCTION

Setting the timer

The timer can only be used if the extractor fan is already on.

1. Press the **TIMER**  key on the right-hand side menu bar and the motor will gradually start slowing down until turning off completely. When the extractor fan stops, the hood and the light will turn off.

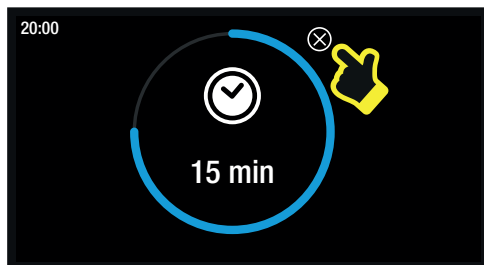

ALARM FUNCTION

Using the audible alarm

1. To set the audible alarm, press the alarm  key on the right-hand side menu bar.
2. After selecting the desired time start the alarm by pressing the arrow on the right-hand side of the screen.

The remaining time is shown next to the clock on the main screen. The alarm will go off when the time is up.

The alarm options are shown in a circle, press **+ MIN** to postpone the alarm duration and **STOP** to cancel it.

The postpone duration can be adjusted in the settings menu.

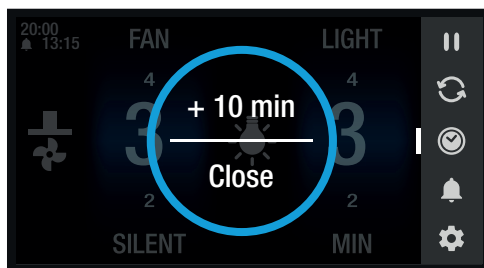
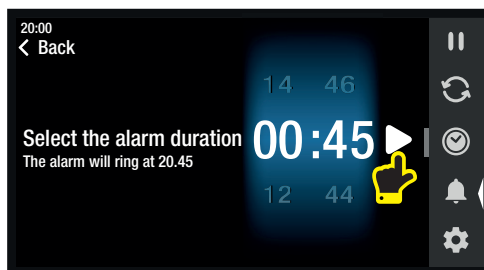

PAUSE MODE

The pause function temporarily stops the extractor fan.

The extractor fan can be restarted by pressing the **PLAY** arrow, which appears above the fan controller.

The timer alarm does not stop during the pause mode and it may go off before the screen is reactivated.





AIR RENOVATION

By pressing the **AIR RENOVATION**  key on the right-hand side menu bar the following two options will appear:

CYCLIC MODE

1. Press the **CYCLIC** key on the left-hand side of the screen (the icon will show blue).

The extraction hood will turn on automatically after 55 minutes for a period of 5 minutes. This will continue until you turn it off.

The **HIBERNATION MODE** does not affect this operation. The screen will show the 5 minutes of operation in progress and then return to the hibernation screen afterwards.

In the settings menu you can set it to work all day, (only during the day or only at night). You can also adjust the power of the extractor fan whilst it is working.

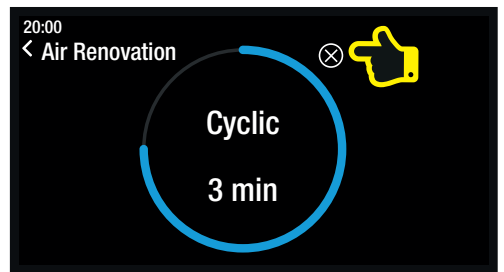
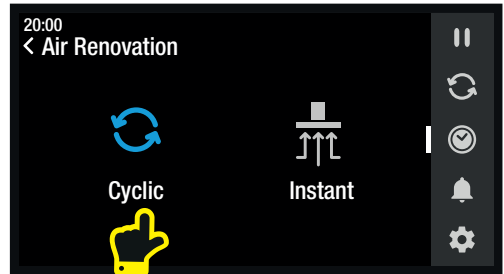

INSTANT MODE

1. Press the **INSTANT** key on the right-hand side of the screen (the icon will show blue).

The extraction hood will turn on for a period of 22 minutes.

The extractor fan will start going at maximum power and will gradually slow down until turning off completely, at which point the screen will also turn off.

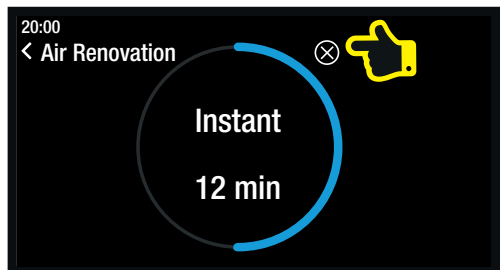
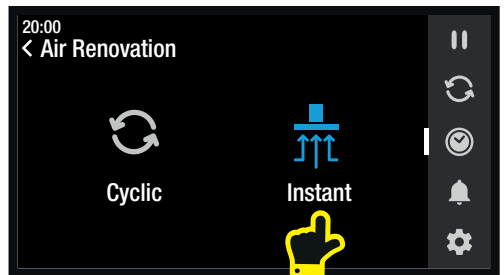



SETTINGS MENU

To access the Settings menu press the Settings icon  on the side bar.

Any changes to the settings are made by returning to the main settings menu.

You will be able to customise the following options for your hood:

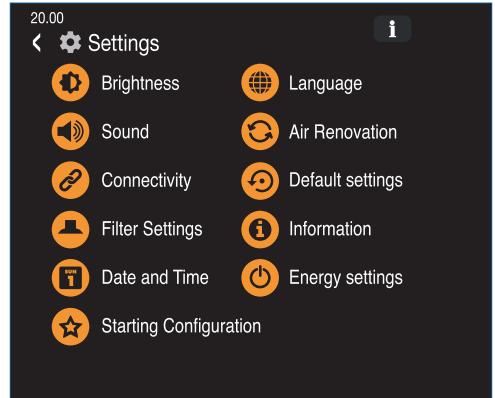

Brightness

Adjust the screen's brightness using the control bar. 

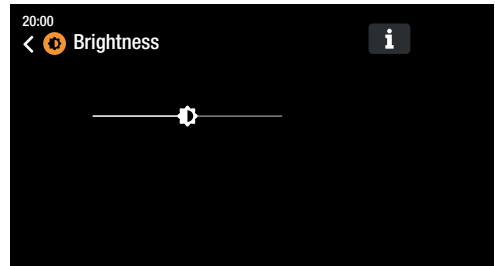

Sound

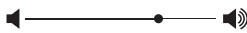
Adjust the volume or mute the sound (except the alarm) using the control bar. 

Turn off the button click sounds.

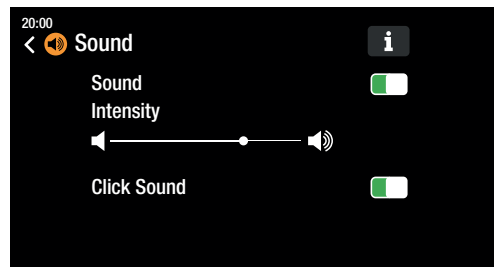

Connectivity

It enables establishing the connection with the hob as long as it is compatible with the hood.

You can also disconnect the hood from the hob.

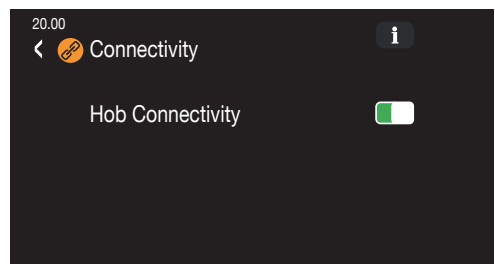



SETTINGS MENU

Date & Time

The date and time options are displayed. Alarm options are also displayed.

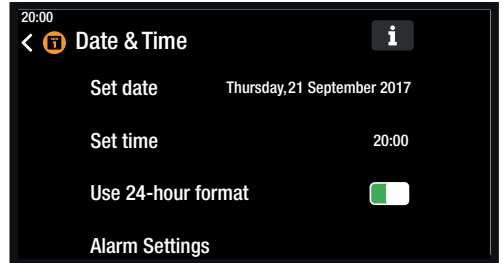

Setting the date

Scroll to adjust the month, date and year. Exit the menu by pressing the arrow top left.



Setting the time

Scroll to adjust the time. Exit the menu by pressing the arrow top left.

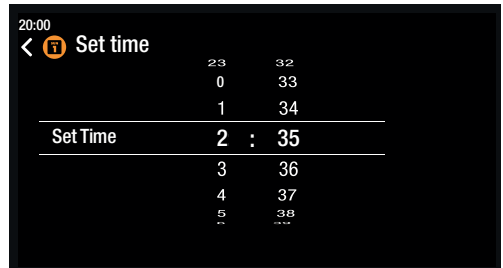

Alarm settings

Adjust the volume or mute the sound (except the alarm) using the control bar.

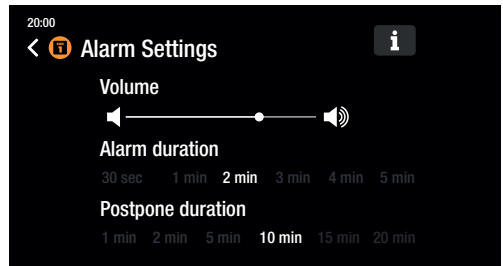



SETTINGS MENU

Filter Settings

Set filter maintenance alerts depending on the type of filter installed in the extraction hood.

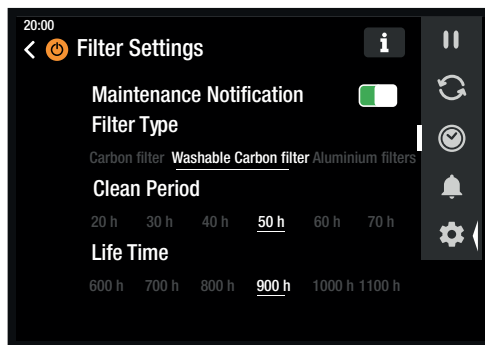

Starting Configuration

Set the power levels for the extractor fan and the light every time the extraction hood is turned on.

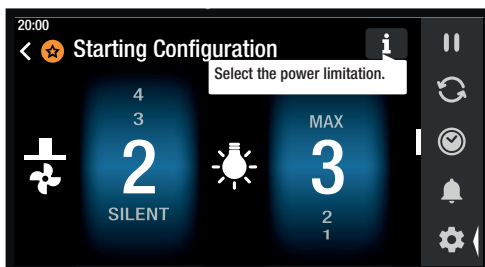

Language

Select the display language.

Setting the language

Click on the required language.
Exit the menu by pressing the arrow top left.



Air Renovation

Allows you to choose the cycles and the power of the extractor fan when the hood is in Cyclic Mode.

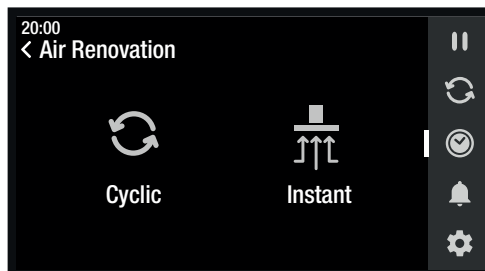



SETTINGS MENU

Default Settings

This option restores all settings back to the initial factory settings.

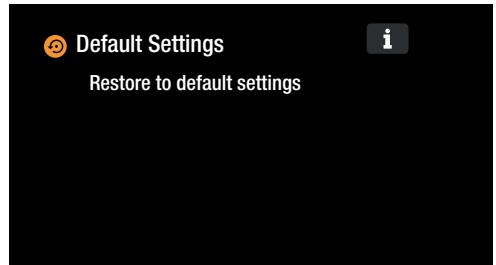

Information

Here you can find useful information about the device and how it works.

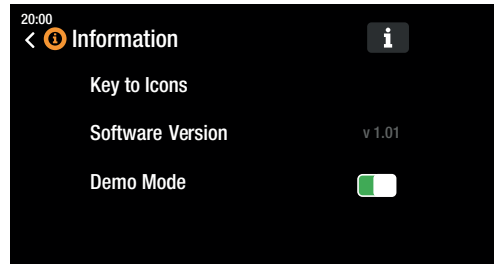

Energy Settings

When **Hibernation Mode** is activated, the screen shows the time after the **Activation Time**. If it is not activated, the screen turns off after the **Activation Time**.

You can adjust both the times and the format of the Hibernation Mode screen.

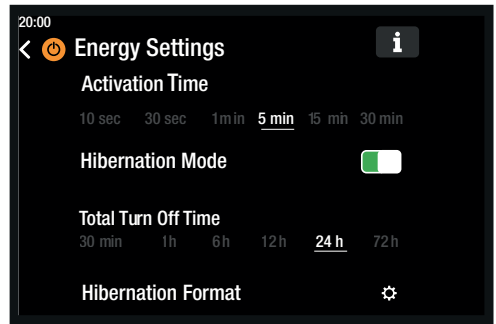



CONNECTIVITY WITH YOUR HOB AND HOOD

You can link a hob with any hood with RF Technology in our range.
Please contact the service department on 0333 247 1128 for advice if you are unsure.

- Once the hood and the hob are linked, the hood can be controlled manually or automatically by pressing the Connectivity Indicator Key  to enable or disable the connection.
- The hob and hood have to be set up to link together.

To achieve this follow the steps for connectivity appropriate to your branded appliance:

A Connecting a KARLSON Hood with a Viceroy Hob

B Connecting a KARLSON Hood with a KARLSON Hob



BEFORE YOU START

Cooker hood and the induction hob must be paired by radio frequency before remote control can occur. This only needs to be done once. When connected, the power output of the induction hob will control the extraction rate of the cooker hood.



A CONNECTING A KARLSON HOOD WITH A VICEROY HOB

Setting up new linking method

The process for connecting a KARLSON hood to a Viceroy hob happens in 3 stages:

A: Configure the hob to transmit a radio frequency signal.

B: Configure the hood to receive this signal.

C: Lock the connectivity between the two appliances and complete the pairing process.

Stage A - Configure hob

1. Turn on the hob and make sure the Connectivity Indicator lamp is lit up.



Note: Touch the Connectivity Key if the Connectivity Indicator is off.



2. Press the keys  and  together on the hob and the connection indicator will flash to confirm connection.

Stage B - Configure hood

1. The hood must be switched on and showing the Home Screen display before proceeding.

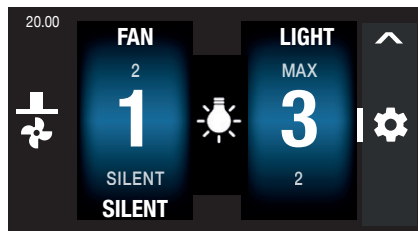

2. Touch the Settings menu to open the Settings Menu of the hood.

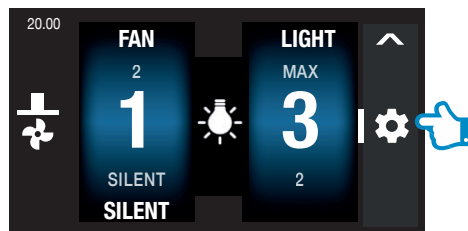

3. Scroll down and touch the 'Connectivity' - go to 'Hob Connectivity'.

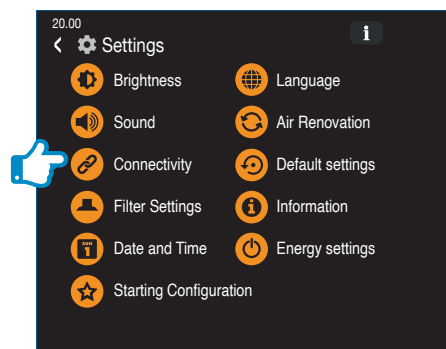

↓ (Stage B continued overleaf)



A CONNECTING A KARLSON HOOD WITH A VICEROY HOB

Stage B (continued)



4. Now touch the hob connection button  on the hood and it will turn green.

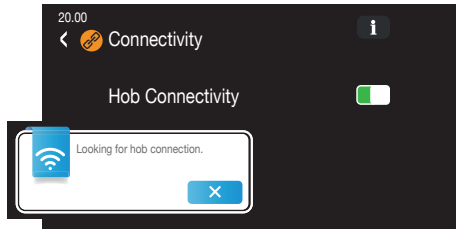
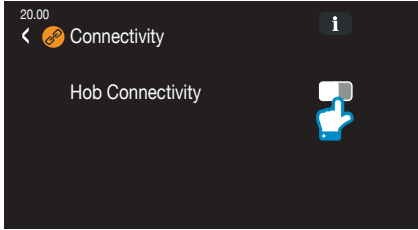

The message '**Looking for hob connection**' will appear in the display. The hood is configured to receive the signal.

Note: The banner disappears and the hob connectivity is disabled if no connection is achieved after 5 minutes.

5. The message '**Hob connected successfully**' will appear once the hood has received the signal. Touch icon  to confirm.

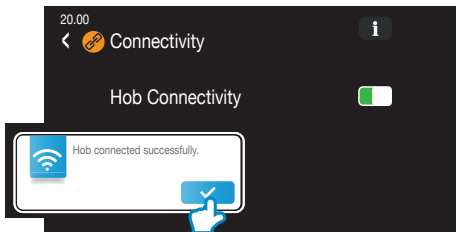

Stage C - Pairing Complete

1. Press the keys  and  together on the hob one more time to store the connectivity settings.



A USING THE CONNECTIVITY FUNCTION

Ensure the Connectivity Indicator is lit on the hob control panel.



IMPORTANT: The extraction rate of the hood will vary based upon the total power output selected on the hob, as shown in the table below. Each hob cooking zone has a maximum rated output of 10 comprising 1-9 and Boost (10).

KARLSON AUTO MODE TABLE		
HOOD LEVEL	HOB LEVEL SUMMARY	
	INTENSE MODE	ECO MODE
SILENT	---	1-5
1	1-4	6-10
2	5-9	11-15
3	10-14	16-21
4	15-19	22-27
BOOSTER	>19	>27

If the hood controls are manually overridden when the hob and hood are linked, the hood will operate for 5 minutes on this manual setting before returning to control by the hob.

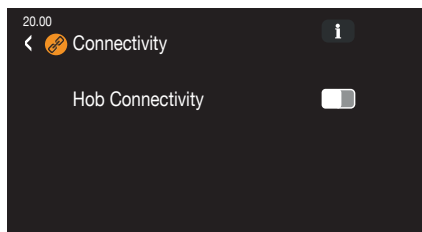
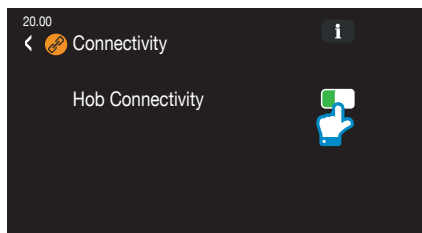
A STOPPING THE CONNECTIVITY FUNCTION



1. Stop the hood connectivity by touching the icon  on the hob and it will turn grey  .

This will end the pairing. The pairing process will need to be repeated to relink the hood and hob.

2. If the hob is switched off, the hood will continue to operate independently in Timer mode and the current speed will flash.

The current speed level of the hood will continue for 5 minutes and step down for 2 minutes at each level until finally switching off.



B CONNECTING A KARLSON HOOD WITH A KARLSON HOB

Setting up new linking method

The process for connecting a KARLSON hood to a KARLSON hob happens in 3 stages:

- A: Configure the hob to transmit a radio frequency signal.**
- B: Configure the hood to receive this signal.**
- C: Lock the connectivity between the two appliances and complete the pairing process.**

Stage A - Configure hob

1. The induction hob must be switched on and showing the Home Screen display before proceeding.

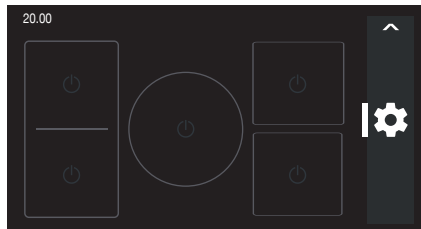

2. Touch the Settings icon to open the Settings Menu of the hob.

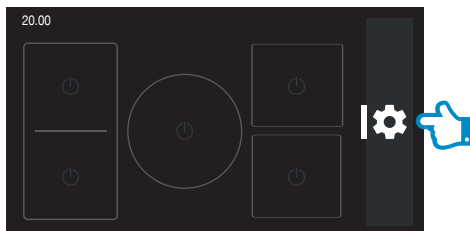

3. Scroll down and touch the 'Hood Options' - go to 'Hood Connectivity'.

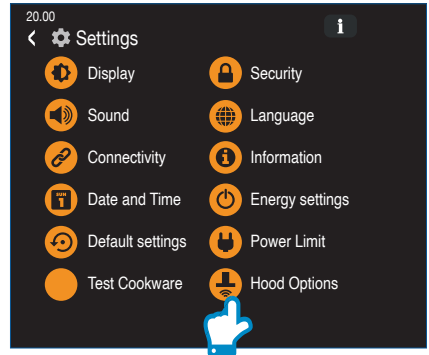

4. Now touch the hood connection button on the hob and it will turn green.

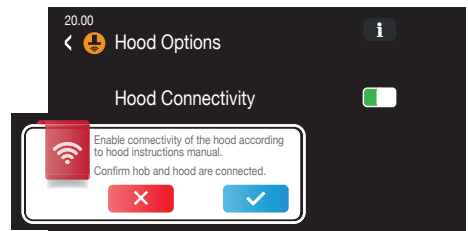
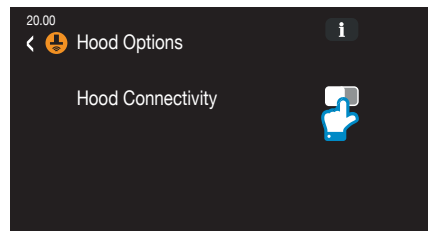

The hob will briefly show a connected message to indicate that the hob is transmitting a radio frequency signal.



B CONNECTING A KARLSON HOOD WITH A KARLSON HOB

Stage B - Configure hood

1. The hood must be switched on and showing the Home Screen display before proceeding.

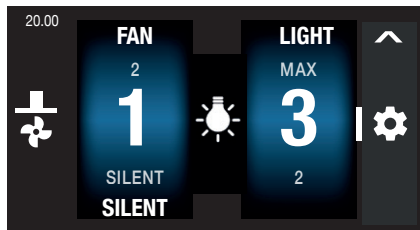

2. Touch the Settings icon to open the Settings Menu of the hood.

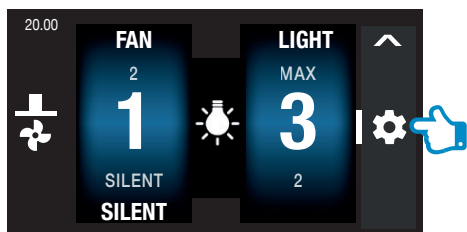

3. Scroll down and touch the 'Connectivity' - go to 'Hob Connectivity'.

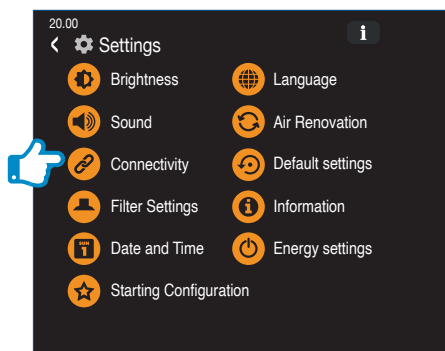

4. Now touch the hob connection button on the hood and it will turn green.

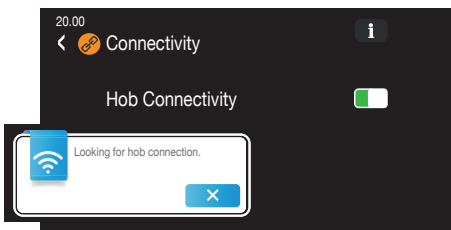
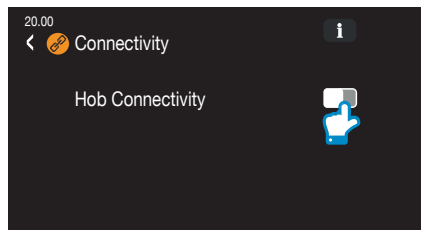

The message 'Looking for hob connection' will appear in the display. The hood is configured to receive the signal.

Note: The banner disappears and the hob connectivity is disabled if no connection is achieved after 5 minutes.

5. The message 'Hob connected successfully' will appear once the hood has received the signal. Touch icon to confirm.

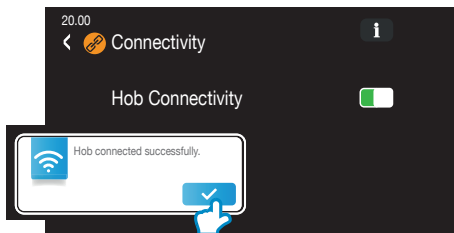



B CONNECTING A KARLSON HOOD WITH A KARLSON HOB

Stage C - Pairing Complete

1. Click to accept hob and hood connection.

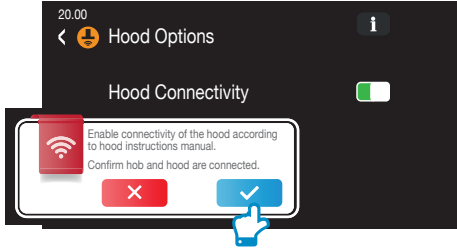

2.

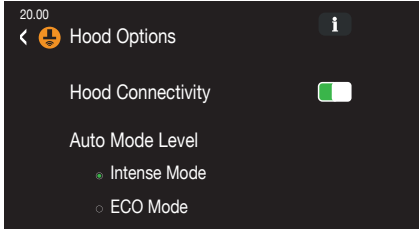

Note: When the 'Hood Connectivity' is activated, the option selected by default must be 'Intense Mode'!

3. The fan icon **A** will display in hob, now the hood and hob indicate pairing is complete.

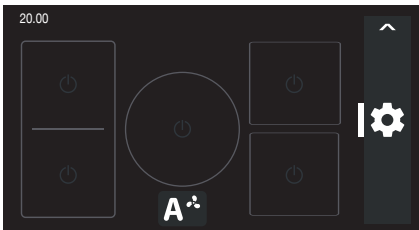



B USING THE CONNECTIVITY FUNCTION

Ensure the Connectivity Indicator is lit on the hob control panel.



IMPORTANT: The extraction rate of the hood will vary based upon the total power output selected on the hob, as shown in the table below. Each hob cooking zone has a maximum rated output of 10 comprising 1-9 and Boost (10).

KARLSON AUTO MODE TABLE		
HOOD LEVEL	HOB LEVEL SUMMARY	
	INTENSE MODE	ECO MODE
SILENT	---	1-5
1	1-4	6-10
2	5-9	11-15
3	10-14	16-21
4	15-19	22-27
BOOSTER	>19	>27

If the hood controls are manually overridden when the hob and hood are linked, the hood will operate for 5 minutes on this manual setting before returning to control by the hob.

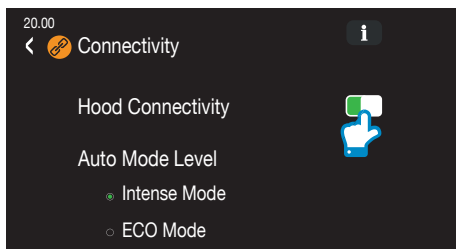
B STOPPING THE CONNECTIVITY FUNCTION



1. Stop the hood connectivity by touching the icon  on the hob and it will turn grey .

This will end the pairing. The pairing process will need to be repeated to relink the hood and hob.

2. If the hob is switched off, the hood will continue to operate independently in Timer mode and the current speed will flash.

The current speed level of the hood will continue for 5 minutes and step down for 2 minutes at each level until finally switching off.

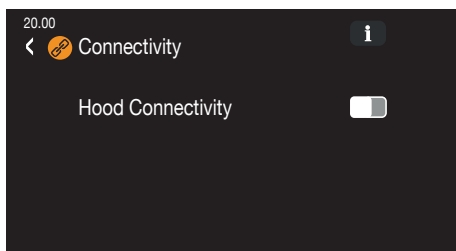



B USING THE CONNECTIVITY FUNCTION

Once the hood is connected to the hob, it can be controlled either manually or automatically and the power levels of the extractor fan and the light are displayed in grey on the hood's screen.

MANUAL MODE

This enables you to adjust the power levels of the fan and the light, pause the fan's operation or start a **Timer** process.

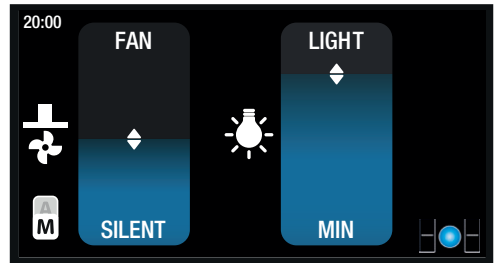

AUTO MODE

The hob automatically controls the hood and calculates the power levels of the extractor fan based on the power levels of the different cooking zones.

The light will continue working even in **MANUAL** mode.

If you adjust the hood values manually from the hob, the mode automatically changes to **MANUAL**.

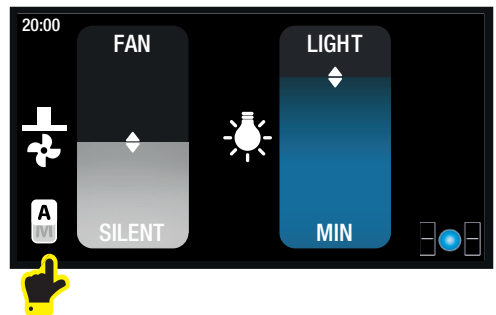

To alternate between MANUAL and AUTO modes:

1. Press the **M** icon on the bottom left-hand part of the control screen for the hood on the hob.

If the values are adjusted manually on the hood or you turn it off while it is connected to the hob, the selected setting will stay the same for 5 minutes before reverting back to those set by the hob.

If the hood had been turned off, it will turn on again after 5 minutes.



LOOKING AFTER YOUR APPLIANCE

WARNING: Always switch off the electrical supply before carrying out maintenance work on the hood. In the event of a fault, contact customer services.

When cleaning the outside use liquid, non-corrosive detergent and avoid using abrasive cleaning products and solvents. Do not use high-pressure or steam cleaning devices.

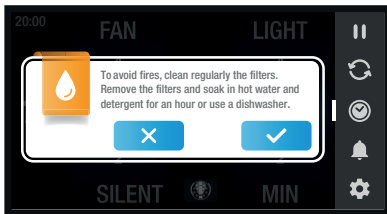

A banner will appear to alert you about when the filters need cleaning or replacing.

See Use section - **Turning your hood on for the first time** to choose and set filters maintenance notifications.

01 Carbon filter replacement



3 MONTHS

Replacement Carbon filters WRFILT50 available online at karlson.co.uk or customer helpline in Service & Spares section.

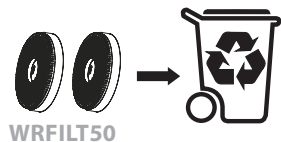
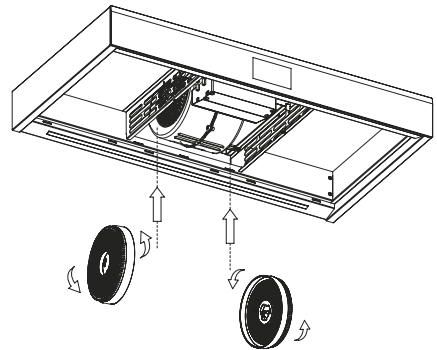

WARNING: Increase the filter cleaning/replacement frequency if the hood is used for more than 2 hours a day. Always use genuine filters from the manufacturer.



LOOKING AFTER YOUR APPLIANCE

02 Washable filters cleaning

Clean thoroughly once a month or whenever a banner alerts you to clean them.

To do so, remove the filters and wash with hot water and detergent. If using a dishwasher (metal parts may turn black without this affecting their functional capacity), load the filters vertically to avoid solid residue from being deposited.



1 MONTH

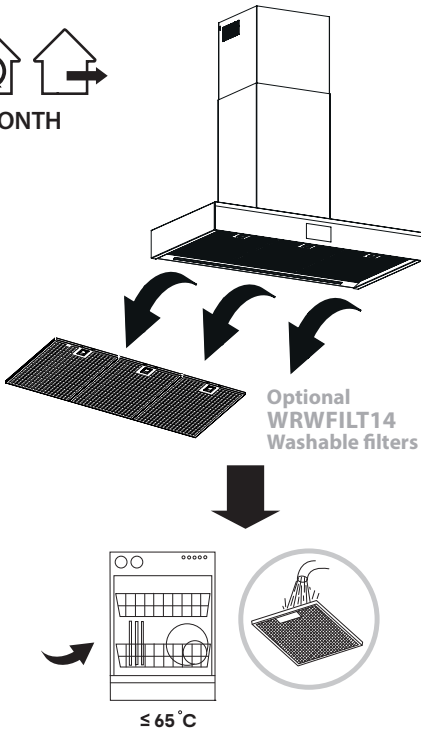

03 Lamp replacement

The LED lamps in this appliance are not replaceable by the consumer. If a lamp fails, please contact the Customer Helpline in Service & Spares section to arrange an engineer visit.

WARNING: Increase the filter cleaning/replacement frequency if the hood is used for more than 2 hours a day. Always use genuine filters from the manufacturer.



AFTER SALES & SERVICE SUPPORT



For after sales, service enquiries & spares support

Please contact: **0333 247 1128**

Monday to Friday: 9am-5pm

Saturday: 9am-1pm

Email enquiries: wrenservice@apelson.co.uk

Dedicated spares online at: karlson.co.uk