

cata 

Culinary Architecture



Built-in kitchen appliances
2022 Spring Collection



Michelin (who publishes the ranking of the World's 50 best restaurants every year) has repeatedly named **El Celler de Can Roca**, as the best restaurant in the world. With this recognition, **El Celler de Can Roca** has reached the very peak in world cuisine.

Cata is proud to be working together with the Roca brothers on developing products that will help bring Michelin Star cooking to your home. Thanks to Cata's collaboration with **El Celler de Can Rocca** the knowledge and experience of master chef's can be built into the performance and functionality of our products.



Contents

Ovens	8
Multi function ovens	12
45cm Combi oven & microwave	14
Microwave & grill	15
Warming drawer	16
Hobs	18
Induction downdrafts	22
Induction hobs	23
Gas Hobs	29
Hoods	32
Downdraft hoods	36
Wall mounted hoods	38
Ceiling Hoods	45
Integrated Canopy Hoods	46
Glass Canopy hoods	48
Chimney Hoods	50
Cooling	52
Wine Coolers	54
Integrated Fridge Freezers	56
Tall Larder Fridge	58
Tall Larder Freezer	59
Undercounter Fridge	60
Undercounter Freezer	61
Washing	62
Integrated Washing Machine	66
Integrated Washer Dryer	67
Dishwasher	68
Technical Specifications	70

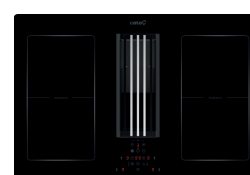

Cata Appliances



CATA ELECTRODOMESTICOS SL, manufacturer of household appliances, was founded in Spain in 1947. Since then, we have been pioneers in domestic extraction and surface cooking. We are a global manufacturer, with production facilities across 3 continents. Our Global product portfolio includes downdraft extractors, hoods, hobs, ovens, microwaves, sinks & taps, dishwashers, washing machines, refrigerators, wine coolers, bathroom extractors, air purifiers and kitchenware.

At CATA we are constantly researching the next innovation. We only use top-quality components together with the latest manufacturing techniques to deliver the best possible user experience, backed by reliability and efficiency. Our range of products is supported by a UK wide supply chain and service network, in order to ensure that we maintain the highest level of commitment to our customers.

Efficiency & Quality



At CATA we are committed to protecting the environment in which we live and believe that your kitchen can lead the way in energy efficiency. We strive to develop products that create a more sustainable, clean and welcoming world.



Our low energy appliances will contribute to a better climate for our children as well reducing energy costs for today.



As a measure of the quality and reliability of our appliances, we offer a FREE 5 year parts & labour warranty* on selected products featured in this brochure.

*subject to registration

Integrated Appliance Range







Stylish Technology

With clever technology and a sleek appearance, Cata ovens are reliable, easy to use, and come with lots of extra features to help you deliver delicious meals every day.

Our built-in ovens are designed to fit seamlessly underneath your kitchen worktop, or within a column for convenient eye-level cooking.

Used as a standalone oven or combined within a bank of appliances Cata provides 60cm single ovens, 45cm Combi microwaves and a 15cm warming drawer.

Taking care of your family with a delicious home-cooked meal has never been easier - grill, bake and roast in one multi-function oven. Handy features such as programmable timers, easy-clean enamel interiors and inner doors take the effort out of cooking.

Cooking can be easily managed with a programmable timer or minute minder. The programmable timer can be set for a specific time and will turn the oven on or off after the time has elapsed. The minute minder will count down for the specified time and will sound an alarm at the end of that period, but the oven will remain on.



Ovens



Fan controlled cooking offers even cooking as the heat generated by the element at the back of the oven is circulated around the cavity by the fan. This function allows simultaneous cooking on all levels without the transfer of flavours. The function means that little preheating is required using less energy and it even keeps the oven cleaner.



Conventional cooking is ideal for traditional style cooking using heat from the top and bottom of the oven. This function delivers perfect results for bread, cakes, tarts and pastries.



Base heat can be used for cooking cakes, biscuits and is also an ideal function for slow cooking.



The **Pizza function** uniformly distributes the heat generated at the bottom of the oven. This setting is ideal for pizzas and ensures a perfectly crisp base and a delicious melted topping. This function is also great for quiches and flans.



Fan assisted cooking is ideal for a variety of dishes from meat to fish to casseroles.



Turbo grill is ideal for grilling portions of meat and poultry, giving a crisp outside and a succulent inside. The fan and grill elements operate at the same time, with the fan circulating heat whilst the food is cooking. This function is perfect for cooking the "Great British Breakfast".



The **Dual grill** delivers full width variable grilling. The inner and outer part of the grill is used giving full and even coverage.



The **Single economy grill** uses less energy, only the inner part of the grill is used – ideal for burgers, fish fingers, bacon or the odd slice of toast.



The **defrost function** is suitable for defrosting any type of food, from meat and vegetables to delicate items such as cream cakes. In ovens the fan circulates air around the food at room temperature defrosting in less than half the time.



Keep warm setting is available on the ovens, combi microwave and warming drawer. A low heat is generated keeping food warm without drying out. It is also perfect for warming plates, serving a hot meal every time.



Bread/Fermentation is available on the ovens and warming drawer and is ideal for bread proofing, yoghurts, pickles and crème fraîche.



The Microwave function is ideal for reheating and cooking ready meals. This method is a quick and efficient – ideal for busy lives.



The combination of **Microwave & grill** allows you to cook meals quickly and efficiently whilst creating a crisp browned finish and without losing flavour.



Combining the **Microwave, grill & fan** delivers all the benefits of fan assisted cooking in a fraction of the time.



The **Automatic programmes** allow you to cook quick and simple meals at the touch of a button. Simply enter the weight and the microwave does the rest.



The **Pause button** will quickly pause both the heating of the food and the timer. Once you are ready to go again re-press the pause button and everything will resume as it was before.



Cooking can be easily managed with a **programmable timer** or **minute minder**. The programmable timer can be set for a specific time and will turn the oven on or off after the time has elapsed. The minute minder will count down for the specified time and will sound an alarm at the end of that period, but the oven will remain on.



The **Child lock** can be activated on ovens and microwaves to prevent accidental tampering. Just hold down two keys for a few seconds to provide an extra level of safety for your family.

Multifunction Oven with Touch Controls



COE615BK

Black glass



11 Oven Functions

- Fan cooking
- Conventional cooking
- Base heat (slow cooking)
- Fan + base heat (pizza cooking)
- Fan assisted cooking
- Turbo grill
- Dual grill
- Single Grill
- Defrost
- Keep Warm
- Fermentation function (bread proofing & yoghurt)

Oven Features

- Touch controls
- Animated LCD display
- Electronic clock, minute minder & programmable oven timer
- Temperature indicator
- Digital temperature control
- Pause function
- Easy clean enamel interior
- Chrome side racks with 5 cooking levels
- Double glazed door with easy clean removable inner glass
- Bright oven light
- Unbranded to match any kitchen

Dimensions (MM)

Built-in aperture: H590 x W560 x D540

Volume

58 litre capacity

Accessories

- 1 chrome wire shelf
- 1 full width grill pan & trivet



5 years
parts & labour



For technical information see page 70

60cm Multifunction Electric Oven



COE600BKX

Black Glass with Stainless Steel

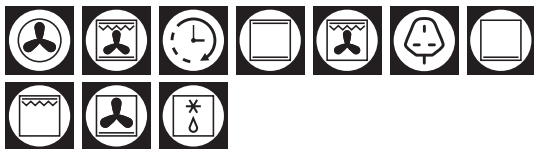

8 Oven Functions

- Fan cooking
- Conventional cooking
- Base heat (slow cooking)
- Fan + base heat (pizza cooking)
- Fan assisted cooking
- Turbo grill
- Dual grill
- Defrost

Oven Features

- Retractable controls
- Electronic clock, minute minder & programmable oven timer
- Easy clean enamel interior
- Double glazed door with easy clean inner glass & large viewing window
- Bright oven light
- 13amp fitted plug
- Unbranded to match any kitchen

Dimensions (MM)

Built-in aperture: H590 x W560 x D570

Volume

70 litre capacity



5 years
parts & labour



For technical information see page 70

45cm Combination Oven & Microwave



COM450BKX

Black Glass with Stainless Steel

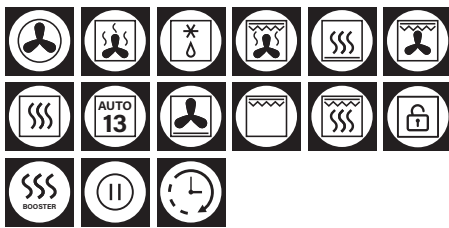

10 Oven Functions & 13 Automatic Programmes

- Fan Cooking
- Microwave & Base heat
- Fan + Base heat (Pizza Cooking)
- Microwave & Fan
- Turbo Grill
- Dual grill
- Defrost
- Microwave
- Microwave & Grill
- Fan, Microwave & Grill

Oven Features

- Retractable & touch controls
- Electronic clock, minute minder & programmable oven timer
- Rapid preheat (Booster)
- Weight & power settings
- Pause function
- Microwave power 100W to 900W
- Child lock
- Unbranded to match any kitchen

Dimensions (MM)

Built-in aperture: H454 x W595 x D568

Volume

44 litre capacity

Accessories

- 1 chrome wire grill rack
- 1 chrome wire roasting rack
- 360mm glass turn table



5 years
parts & labour

For technical information see page 71

Microwave & Grill



CMG376BK

Black glass



7 Oven Functions

- Microwave
- Speed cook
- Auto defrost
- Full grill
- Low grill
- Microwave & full grill
- Microwave & low grill

Oven Features

- Touch & rotary controls
- Electronic clock with digital display
- 5 power levels
- 700W microwave
- 800W grill
- Automatic oven light
- 13amp fitted plug
- Unbranded to match any kitchen

Accessories

- 1 chrome wire grill rack
- 250mm glass turn table

Dimensions (MM)

Built-in aperture: Built-in aperture: 376 x W592 x D293

Volume

20 litre capacity



2 years
parts & labour

For technical information see page 71

14cm Warming Drawer



CPW141BK

Black glass



5 Functions

- Food warming
- Plate warming
- Defrost
- Dough proving
- Low temperature cooking

Drawer Features

- Touch controls
- Handless push opening
- 6 hour digital timer
- 1000W power
- Adjustable temperature control 40°C to 80°C
- Air vented circulation
- Unbranded to match any kitchen

Accessories

- Anti slip mat

Dimensions (MM)

Built-in aperture: H145 x W560 x D550

Volume

22 litre capacity

25kg capacity



2 years
parts & labour

For technical information see page 70





Hobs

State-of-the-art cooking with innovative features and excellent performance. Cata hobs make an impressive statement in any kitchen. Offering a selection of hob types in different sizes, from the innovation of induction to traditional gas. All hobs have safety features as standard to protect your family while delivering optimum cooking results.

Induction hobs deliver the most responsive form of cooking both in terms of precision and controllability. Induction is the safest and most energy efficient way to cook on a hob. Cata has created 'the best of both worlds' by combining a zoneless induction hob with a high performance downdraft extractor.

Using clever technology beneath a ceramic glass surface, an inductor creates a magnetic field when a pan with suitable iron content is placed on the cooking zone. This magnetic reaction instantly produces heat in the base of the pan. (not within the hob zone itself) As it is the base of the pan that heats up, surrounding areas of the hob remain cool to touch, so it is even possible to wipe clean during cooking) When the pan is lifted from the hob, the only heat on the glass is that which has been transferred back from the pan.

Cata's Gas on Glass hobs offer a stylish touch to this traditional method of cooking. Easy to wipe clean and with all hobs equipped with a powerful 3.5kW triple crown wok burner and safety gas shut off, professional cooking is at your finger tips.

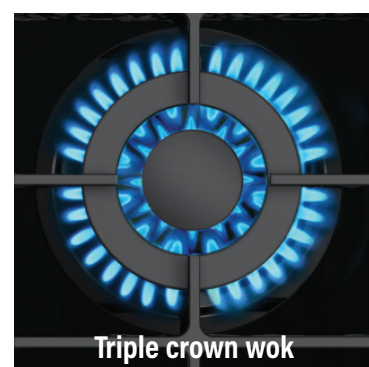
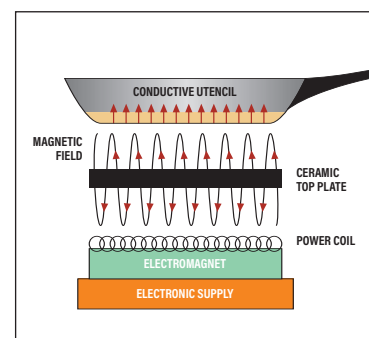

Hobs

All Cata induction hobs come extra features to help you create the tastiest of meals.

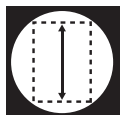

Flexible zoneless areas give you freedom to cook anywhere within the defined area. This feature combines multiple inductors to create a larger more flexible zone, ideal for larger cookware or for controlling multiple pots at the same temperature at a single touch.



Cooking can be easily managed with a **programmable timer** or **minute minder**. The programmable timer can be set for a specific time and will turn the hob off after the time has elapsed. The minute minder will count down for the specified time and will sound an alarm at the end of that period, but the hob will remain on.



The **booster function** diverts extra power to each zone selected delivering rapid heating in the shortest possible time.



The **pause function** will simultaneously pause all cooking zones along with any timers that are in operation. Once you are ready to go again re-press the pause button and everything will resume as it was before.



The **Keep warm** setting brings the cooking zone down to a steady low heat, keeping food warm without drying out, for when you are ready to serve.



The **TFT** utilises intuitive touchscreen technology to maximum the cooking experience, allowing you to flick through the screen in any direction and select options at the touch of a finger. The animated display helps guide you through the cooking process.



During cooking, the volume of air in the kitchen should be renewed approximately 10 times. The Cata induction downdraft incorporates a high performance extraction motor delivering **580m³/h**, powerful enough to clean the air of even the most demanding kitchen.



Cata offers a complete range of quiet appliances. The induction downdraft can extract and clean the air in your kitchen at **45 dB** – which is the same noise level as bird song.

All Cata induction hobs come with 8 safety features built-in as standard.



Auto-safety shut off. The hob automatically switches off if inadvertently left on. The Switch off period varies based on the combination of time and temperature. Power level 1-3 = 6 hours, 4-6 = 3 hours, 7-8 = 2 hours, 9 = 90 minutes.



The **Child lock** can be activated on electric hobs to prevent accidental tempering. Just hold down the key(s) for a few seconds to provide an extra level of safety for your family.



The **Anti-overheat** feature maintains a safe surface to pan temperature. If the temperature exceeds safe parameters the hob will automatically shut off to prevent pans igniting. The hob will reset once a safe temperature is reached.



The **Anti-overflow** feature automatically shuts the hob off if liquid should happen to boil over onto the control panel.



Automatic pan detection detects when suitable cookware is placed on the cooking zone. This clever safety feature means that the hob will never heat up when there is no pan on the zone.



Residual Heat Indicator. A warning light is displayed on the control panel whilst the surface temperature remains hot to the touch.



Small object detection distinguishes between small items such as cutlery and larger cookware, in order that the cooking zone is not activated accidentally.



Control panel protection detects excessive heat on the control panel, so the hob will automatically shut off if a hot pan is accidentally placed on the controls.

77cm Induction Downdraft with Flexible Cooking Zones

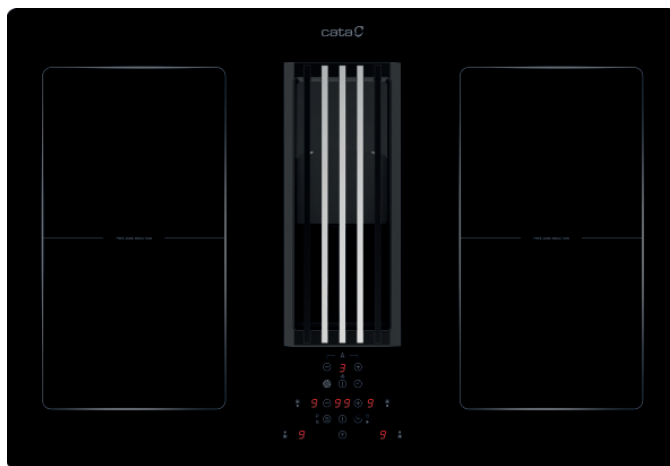

CiDZ770F

Black glass with frameless edge



Hob Features

- 4 separate induction zones with 2 flexible zoneless areas
- Touch controls
- 4 programmable timers with shut off
- 4 programmable minute minders
- Unbranded to match any kitchen

Hob Safety Features

- Auto safety shut off (time & temperature dependant)
- Child lock
- Anti over heat
- Anti over flow
- Automatic pan detection
- Residual heat indicators
- Small object detection
- Control panel protection

12 Power Settings

- 9 power levels per zone
- Separate booster for each zone
- Pause function
- Keep warm function

4 Induction Zones

- Front Left 190x190mm 2.8kW
- Rear Left 190x190mm 2.0kW
- Front Right 190x190 2.8kW
- Rear Right 190x190mm 2.0kW
- Flex zones 190x380mm 3.6kW

Extractor Features

- 5 extraction speeds plus booster
- Maximum extraction level 580m³/h
- Noise level 45-64dB
- Delayed shut off timer
- Metal extractor grill
- 2 metal grease filters (dishwasher safe)
- Automatic extraction mode
- Filter saturation indicator (extractor)

Dimensions (MM)

Built-in aperture: H300 x W750 x D490

Ducting Diameter: 150

Ducting kit accessory for external

extraction: Code KITVENT2

Filter kit for internal

recirculation: Code ICONKIT1



5 years
parts & labour



For technical information see page 74

90cm Induction hob with TFT & flexible cooking zones

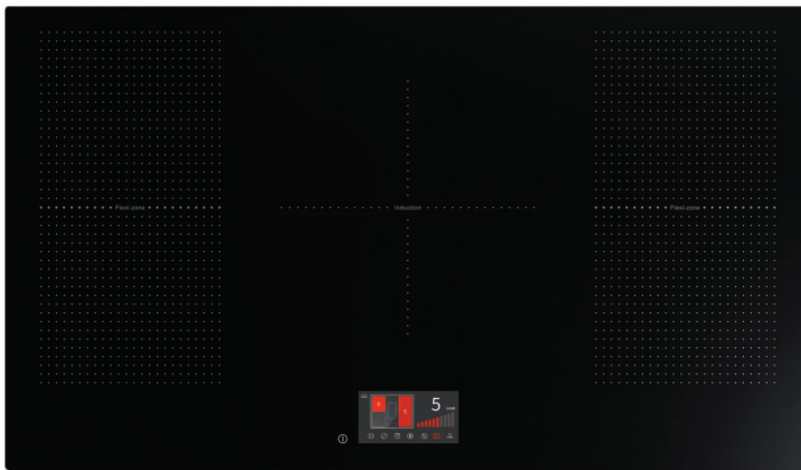

CiHZ940F

Black glass with frameless edge



Hob Features

- 5 separate induction zones with 2 flexible zoneless areas
- Full colour TFT touch screen control
- 5 programmable timers with shut off (up to 6 hours)
- 5 programmable minute minders (up to 6 hours)
- Unbranded to match any kitchen

Hob Safety Features

- Auto safety shut off (time & temperature dependant)
- Child lock
- Anti over heat
- Anti over flow
- Automatic pan detection
- Residual heat indicators
- Small object detection
- Control panel protection

11 Power Settings

- 9 power levels per zone
- Separate booster for each zone
- Pause function for zones & timers

5 Linked Induction Zones

- Front Left 190x190mm 2.8kW
- Rear Left 190x190mm 2.0kW
- Front Right 190x190 2.8kW
- Rear Right 190x190mm 2.0kW
- Centre 280mm 3.0kW
- Flex zones 190x380mm 3.6kW

Dimensions (MM)

Built-in aperture: H65 x W875 x D495



5 years
parts & labour

For technical information see page 74

90cm Induction hob with flexible cooking zones

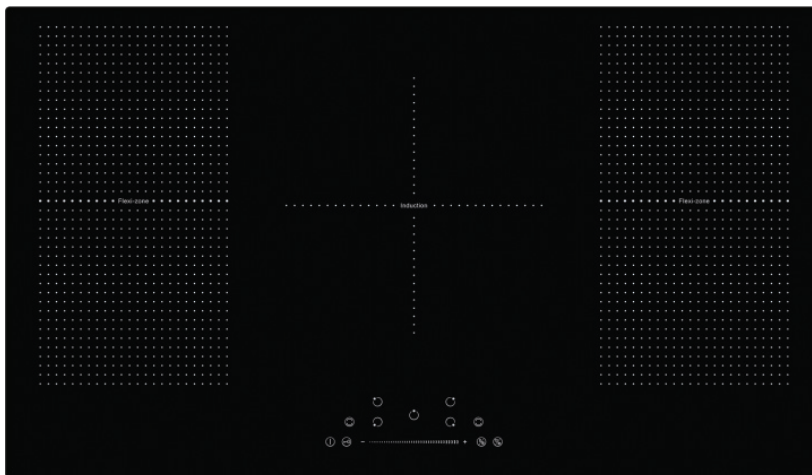

CiHZ910F

Black glass with frameless edge

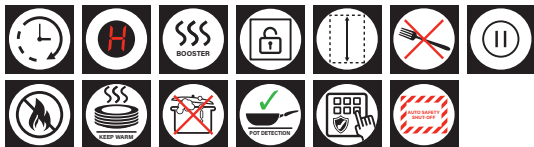

Hob Features

- 5 separate induction zones with 2 flexible zoneless areas
- Touch slider controls
- 5 programmable timers with shut off
- 5 programmable minute minders
- Unbranded to match any kitchen

5 Induction Zones

- Front Left 190x190mm 2.8kW
- Rear Left 190x190mm 2.0kW
- Front Right 190x190 2.8kW
- Rear Right 190x190mm 2.0kW
- Centre 280mm 3.0kW
- Flex zones 190x380mm 3.6kW

12 Power Settings

- 9 power levels per zone
- Separate booster for each zone
- Pause function
- Keep warm function

Safety Features

- Auto safety shut off (time & temperature dependant)
- Child lock
- Anti over heat
- Anti over flow
- Automatic pan detection
- Residual heat indicators
- Small object detection
- Control panel protection

Dimensions (MM)

Built-in aperture: H56 x W875 x D495



2 years
parts & labour

For technical information see page 74

90cm Slimline Induction hob with flexible cooking zones

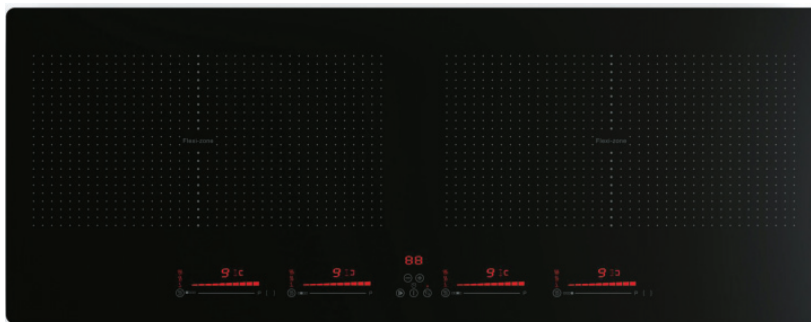

CiHZ905F

Black glass with frameless edge

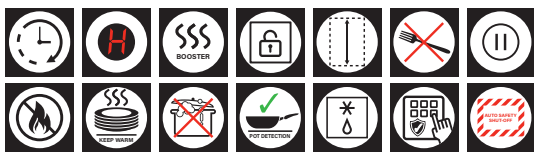

Hob Features

- 4 separate induction zones with 2 flexible zoneless areas
- Touch slider controls
- 4 programmable timers with shut off
- 4 programmable minute minders
- Unbranded to match any kitchen

4 Induction Zones

- Far Left 190x190mm 2.8kW
- Inner Left 190x190mm 2.0kW
- Far Right 190x190 2.8kW
- Inner Right 190x190mm 2.0kW
- Flex zones 190x380mm 3.6kW

14 Power Settings

- 9 power levels per zone
- Separate booster for each zone
- Pause function
- Keep warm function
- Defrost / melt function
- Simmer function

Safety Features

- Auto safety shut off (time & temperature dependant)
- Child lock
- Anti over heat
- Anti over flow
- Automatic pan detection
- Residual heat indicators
- Small object detection
- Control panel protection

Dimensions (MM)

Built-in aperture: H56 x W875 x D325



5 years
parts & labour

For technical information see page 74

60cm Induction hob with TFT & flexible cooking zones

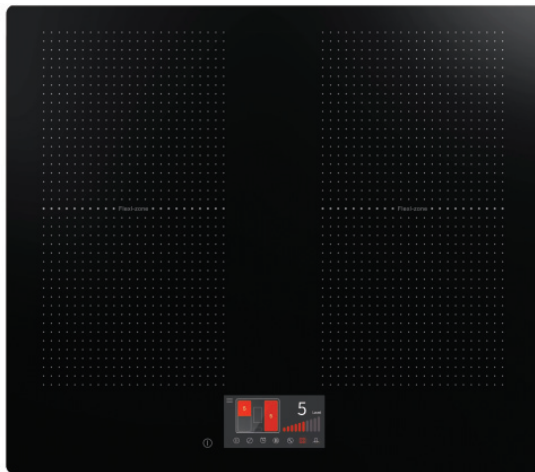

CiHZ640F

Black glass with frameless edge



Hob Features

- 4 separate induction zones with 2 flexible zoneless areas
- Full colour TFT touch screen control
- 4 programmable timers with shut off (up to 6 hours)
- 4 programmable minute minders (up to 6 hours)
- Unbranded to match any kitchen

4 Linked Induction Zones

- Front Left 190x190mm 2.8kW
- Rear Left 190x190mm 2.0kW
- Front Right 190x190 2.8kW
- Rear Right 190x190mm 2.0kW
- Flex zones 190x380mm 3.6kW

11 Power Settings

- 9 power levels per zone
- Separate booster for each zone
- Pause function for zones & timers

Safety Features

- Auto safety shut off (time & temperature dependant)
- Child lock
- Anti over heat
- Anti over flow
- Automatic pan detection
- Residual heat indicators
- Small object detection
- Control panel protection

Dimensions (MM)

Built-in aperture: H65 x W565 x D495



5 years
parts & labour

For technical information see page 74

60cm 4 Zone Induction hob with flexible cooking zones

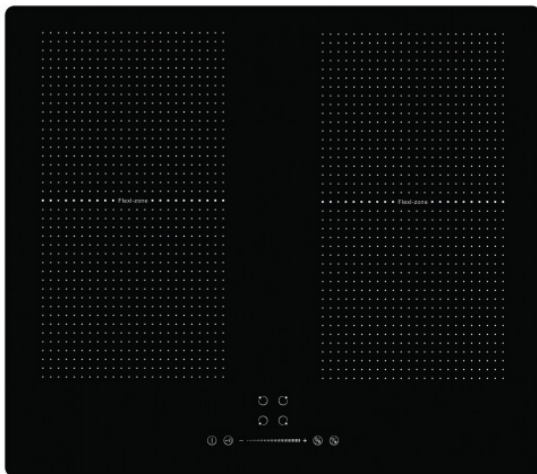

CiHZ610F

Black glass with frameless edge



Hob Features

- 4 separate induction zones with 2 flexible zoneless areas
- Touch slider controls
- 4 programmable timers with shut off
- 4 programmable minute minders
- Switchable 13amp or 32amp supply
- Unbranded to match any kitchen

4 Induction Zones

- Front Left 190x190mm 2.8kW
- Rear Left 190x190mm 2.0kW
- Front Right 190x190 2.8kW
- Rear Right 190x190mm 2.0kW
- Flex zones 190x380mm 3.6kW

12 Power Settings

- 9 power levels per zone
- Separate booster for each zone
- Pause function
- Keep warm function

Safety Features

- Auto safety shut off (time & temperature dependant)
- Child lock
- Anti over heat
- Anti over flow
- Automatic pan detection
- Residual heat indicators
- Small object detection
- Control panel protection

Dimensions (MM)

Built-in aperture: H56 x W565 x D495



2 years
parts & labour

For technical information see page 74

60cm 4 Zone Induction hob

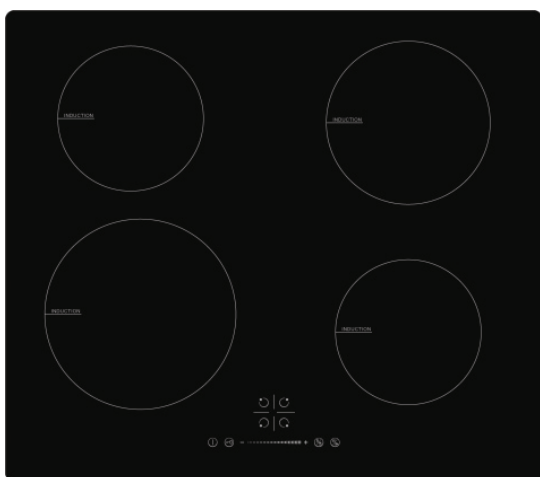

CiH600F

Black glass with frameless edge



Hob Features

- 4 separate induction zones
- Touch slider controls
- Digital touch controls
- 4 programmable timers with shut off
- 4 programmable minute minders
- Switchable 13amp or 32amp supply
- Unbranded to match any kitchen

4 Induction Zones

- Front Left Ø190mm 1.8kW
- Rear Left Ø155mm 1.2kW
- Front Right Ø155mm 1.2kW
- Rear Right Ø190mm 1.8kW

11 Power Settings

- 9 power levels per zone
- Separate booster for each zone
- Pause function for zones & timers

Safety Features

- Auto safety shut off (time & temperature dependant)
- Child lock
- Anti over heat
- Anti over flow
- Automatic pan detection
- Residual heat indicators
- Small object detection
- Control panel protection

Dimensions (MM)

Built-in aperture: H58 x W560 x D490



2 years
parts & labour

For technical information see page 74

90cm Gas on Glass Hob with Triple Crown Burner

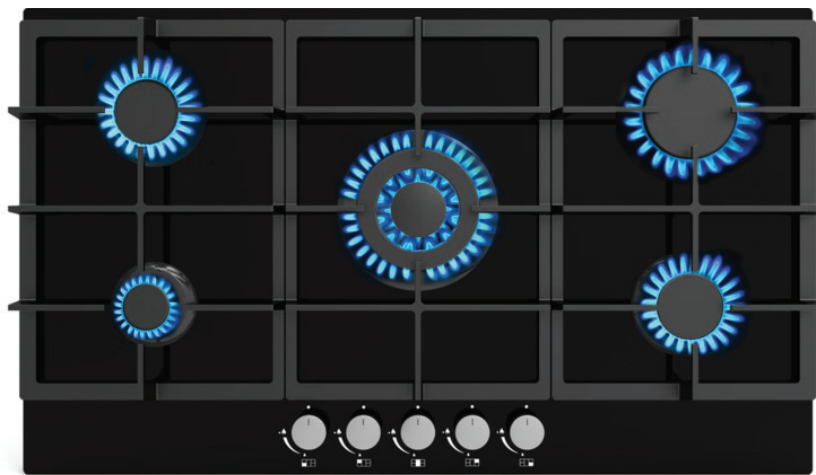

CGH900F

Black glass with frameless edge

Hob Features

- 5 pureflame burners
- Triple crown burner
- Cast iron pan supports
- Front rotary controls
- Integrated ignition
- Gas safety cut off
- LPG (bottled gas) conversion kit included
- Unbranded to match any kitchen

5 Cooking Zones

- Front Left - auxiliary 1.0kW
- Rear Left - semi-rapid 1.75kW
- Front Right semi-rapid 1.75kW
- Rear Right - rapid 3.0kW
- Centre - wok 3.5kW

Dimensions (MM)

Built-in aperture: H40 x W830 x D480



2 years
parts & labour

For technical information see page 75

70cm Gas on Glass Hob with Triple Crown Burner

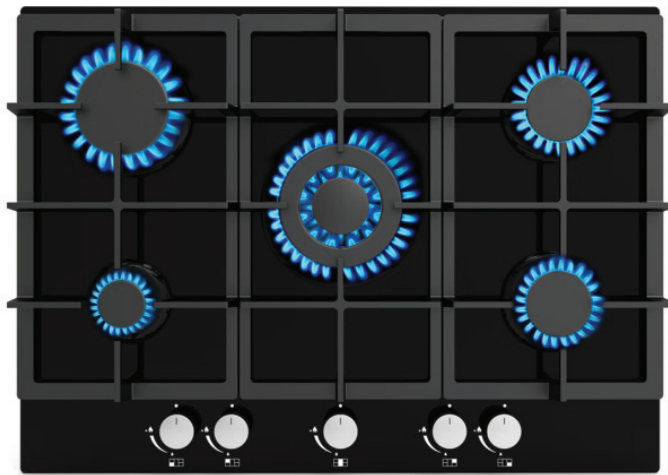

CGH700F

Black glass with frameless edge

Hob Features

- 5 pureflame burners
- Triple crown burner
- Cast iron pan supports
- Front rotary controls
- Integrated ignition
- Gas safety cut off
- LPG (bottled gas) conversion kit included
- Unbranded to match any kitchen

5 Cooking Zones

- Front Left - auxiliary 1.0kW
- Rear Left - rapid 3.0kW
- Front Right semi-rapid 1.75kW
- Rear Right - semi-rapid 1.75kW
- Centre - wok 3.5kW

Dimensions (MM)

Built-in aperture: H40 x W560 x D480



2 years
parts & labour

For technical information see page 75

64cm Gas on Glass Hob with Triple Crown Burner

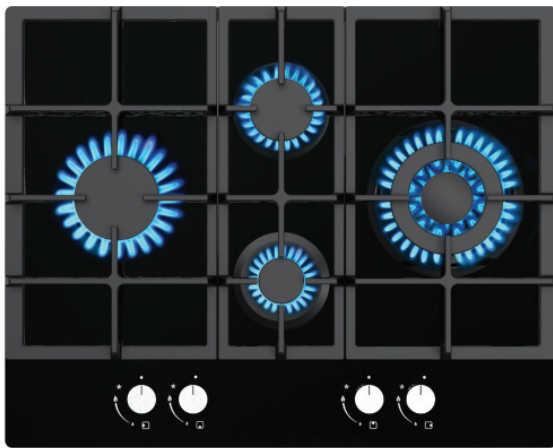

CGH600F

Black glass with frameless edge

Hob Features

- 4 pureflame burners
- Triple crown burner
- Cast iron pan supports
- Front rotary controls
- Integrated ignition
- Gas safety cut off
- LPG (bottled gas) conversion kit included
- Unbranded to match any kitchen

4 Cooking Zones

- Left - rapid 3.0kW
- Right - wok 3.5kW
- Centre back- semi-rapid 1.75kW
- Centre front – auxiliary 1.0kW

Dimensions (MM)

Built-in aperture: H40 x W550 x D475



2 years
parts & labour

For technical information see page 75



Hoods

Hoods can provide a stunning focal to any kitchen or be discreetly integrated into the kitchen furniture or ceiling. Powerful yet quiet, the Cata range of hoods provides a breath of fresh air when cooking your favourite dishes.

With a diversity of styles and dimensions, there is a model to suit every preference, from designer wall hoods to island hoods and fully integrated downdraft and canopy extractors.

All Cata hoods are equipped with metal grease filters, which capture and lock away the grease from cooking fumes. Once saturated they can be easily removed and cleaned in a dishwasher. All extractors have the option of recirculation using a charcoal filter or extracting outside via 150mm ducting kit.

Cata hoods come with a range of innovative features, such as digital touch controls, delayed shut off, perimeter aspiration and adjustable lighting, to deliver a cleaner, quieter, easier cooking experience.



Hood Types



Downdraft extractors are designed to be integrated at hob height into kitchen units. When extraction is required, the downdraft elevates above pan height to provide maximum extraction and can then be retracted when not in use. With touch control and digital display, these models feature 4 power levels and delayed stop. Available in 60cm and 90cm widths to suit any hob.



The **ceiling extractor's** integrated design provides a sleek and natural appearance, particularly when installed above island units. The powerful extraction unit not only efficiently cleans the air, but also provides ambient lighting, with which to enjoy your meal.



Beautifully styled, the **glass canopy hoods** fuse the cleanability of glass with the professional look of stainless steel. With touch control and digital display, these models feature 6 power levels and delayed stop. Available in 60cm and 90cm widths to suit any hob.



During cooking, the volume of air in the kitchen should be renewed approximately 10 times. Cata hoods have high performance motors delivering extraction levels up to **850m³/h**, powerful enough to clean the air of even the most demanding kitchen.



When cooking has finished the hood should continue to extract in order to clean the remaining particles from the air. Cata extractors feature **delayed shut off timers**, so you can sit down to enjoy your meal, let the hood finish doing the work and then shut down automatically.



Cata offers a complete range of quiet appliances. Hoods can extract and clean the air in your kitchen at noise levels as low as **36 dB** – which is about as loud as a whisper.

Designer wall hoods offer stunning design with outstanding performance and create a distinctive look in any kitchen. Models are available in the ultra modern vertical style or angled slightly over the hob. All models feature touch controls, perimeter aspiration and delayed stop. Available in 60cm, 70cm, 80cm and 90cm widths to suit any hob.



Integrated canopy hoods blend in perfectly with the kitchen furniture and are the most versatile type of hood as they will fit within wall, island or corner units. With touch controls, these models feature 3 power levels and delayed stop. Available in 52cm and 75cm widths to suit any hob.



Either in black or stainless steel **Chimney hoods** give a professional look to a kitchen. They can be fitted to a wall as a stand alone feature or installed between furniture. Available in 60cm and 90cm widths to suit any hob.



Perimeter Aspiration system uses a panel of glass to create a 'venturi' effect, which helps to capture smoke, steam, grease and oil more effectively. This makes extraction quieter, more powerful and more energy efficient.



The **booster function** gives additional extraction power to the hood for a fixed period of time. Ideal for the more intense periods during cooking, such as frying a steak.

88cm Downdraft Extractor



CHD630BKX

Black Glass with Stainless Steel



Hood Features

- Digital touch & slider controls
- 4 extraction speeds
- Motorised lift system
- Concealed when not in use to give flush finish
- Perimeter aspiration
- Maximum extraction level 590m³/h
- Noise level 52-73dB
- 2 adjustable cool white LED hob lights
- Delayed shut off timer
- Metal grease filter (dishwasher safe)
- For use with gas, ceramic and induction hobs
- Unbranded to match any kitchen

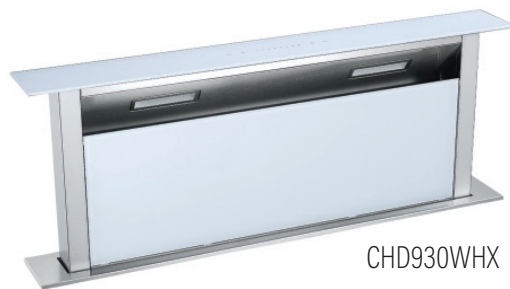

CHD930WHX

White glass with stainless steel

Dimensions (MM)

- Built-in aperture: H718 x W792 x D341
- Ducting Diameter: 150
- Ducting kit accessory for external extraction: Code KITVENT2
- Filter kit for internal recirculation: Code ATFILT4



5 years
parts & labour



For technical information see page 78

58cm Downdraft Extractor



CHD630BKX

Black Glass with Stainless Steel



Hood Features

- Digital touch & slider controls
- 4 extraction speeds
- Motorised lift system
- Concealed when not in use to give flush finish
- Perimeter aspiration
- Maximum extraction level 590m³/h
- Noise level 52-73dB
- 2 adjustable cool white LED hob lights
- Delayed shut off timer
- Metal grease filter (dishwasher safe)
- For use with gas, ceramic and induction hobs
- Unbranded to match any kitchen



CHD630WHX

White glass with stainless steel

Dimensions (MM)

- Built-in aperture: H718 x W580 x D341
- Ducting Diameter: 150
- Ducting kit accessory for external extraction:
Code KITVENT2
- Filter kit for internal recirculation: Code ATFILT3



5 years
parts & labour



For technical information see page 78

90cm Vertical Wall Hood



CHW950BKX

Black Glass with Stainless Steel



Hood Features

- Digital touch controls
- 4 extraction speeds (including booster)
- Opening front panel for intensive extraction
- Perimeter aspiration
- Maximum extraction level 850m³/h
- Noise level 50-65dB
- Cool white LED adjustable hob lights
- Delayed shut off timer
- Metal grease filter (dishwasher safe)
- Anti condensation filter
- Filter saturation indicator
- For use with gas, ceramic and induction hobs

Dimensions (MM)

- Overall : H755-1070 x W900 x D290
- Ducting Diameter: 150
- Ducting kit accessory for external extraction: Code KITVENT2
- Filter kit for internal recirculation: Code 02859398



5 years
parts & labour



For technical information see page 78

80cm Vertical Wall Hood



CHW850BKX

Black Glass with Stainless Steel



Hood Features

- Digital touch controls
- 4 extraction speeds (including booster)
- Opening front panel for intensive extraction
- Perimeter aspiration
- Maximum extraction level 850m³/h
- Noise level 50-65dB
- Cool white LED adjustable hob lights
- Delayed shut off timer
- Metal grease filter (dishwasher safe)
- Anti condensation filter
- Filter saturation indicator
- For use with gas, ceramic and induction hobs



CHW850GRX

Gunmetal Glass with Stainless Steel

Dimensions (MM)

- Overall 90cm: : H755-1070 x W800 x D290
- Ducting Diameter: 150
- Ducting kit accessory for external extraction: Code KITVENT2
- Filter kit for internal recirculation: Code 02859398



5 years
parts & labour



For technical information see page 78

90cm Wall Hood



CHW930BKX

Black Glass with Stainless Steel



Hood Features

- Digital touch controls
- 6 extraction speeds (including booster)
- Perimeter aspiration
- Maximum extraction level 575m³/h
- Noise level 44-61dB
- Cool white LED adjustable hob lights
- Delayed shut off timer
- Metal grease filter (dishwasher safe)
- Filter saturation indicator
- For use with gas, ceramic and induction hobs

Dimensions (MM)

- Overall: H845-1130 x W900 x D306
- Ducting Diameter: 150
- Ducting kit accessory for external extraction: Code KITVENT2
- Filter kit for internal recirculation: Code 02859394



5 years
parts & labour



For technical information see page 78

70cm Wall Hood



CHW730BKX

Black Glass with Stainless Steel



Hood Features

- Digital touch controls
- 6 extraction speeds (including booster)
- Perimeter aspiration
- Maximum extraction level 575m³/h
- Noise level 44-61dB
- Cool white LED adjustable hob lights
- Delayed shut off timer
- Metal grease filter (dishwasher safe)
- Filter saturation indicator
- For use with gas, ceramic and induction hobs

Dimensions (MM)

- Overall: H845-1130 x W700 x D306
- Ducting Diameter: 150
- Ducting kit accessory for external extraction: Code KITVENT2
- Filter kit for internal recirculation: Code 02859394



5 years
parts & labour



For technical information see page 78

60cm Wall Hood



CHW630BKX

Black Glass with Stainless Steel



Hood Features

- Digital touch controls
- 6 extraction speeds (including booster)
- Perimeter aspiration
- Maximum extraction level 575m³/h
- Noise level 44-61dB
- Cool white LED adjustable hob lights
- Delayed shut off timer
- Metal grease filter (dishwasher safe)
- Filter saturation indicator
- For use with gas, ceramic and induction hobs

Dimensions (MM)

- Overall: H845-1130 x W600 x D306
- Ducting Diameter: 150
- Ducting kit accessory for external extraction: Code KITVENT2
- Filter kit for internal recirculation: Code 02859394



5 years
parts & labour



For technical information see page 78

90cm Wall Hood



CHW900BK

Black Glass



Hood Features

- Digital touch controls
- 9 extraction speeds
- Silent brushless motor
- Perimeter aspiration
- Maximum extraction level 523m³/h
- Noise level 43-62dB
- 2 Cool white LED hob lights
- Delayed shut off timer
- Metal grease filter (dishwasher safe)
- For use with gas, ceramic and induction hobs
- Unbranded to match any kitchen

Dimensions (MM)

- Overall : H775-1090 x W895 x D385
- Ducting Diameter: 150
- Ducting kit accessory for external extraction: Code KITVENT2
- Filter kit for internal recirculation: Code TMFILT4



2 years
parts & labour



For technical information see page 78

60cm Wall Hood



CHW600

Black Glass



Hood Features

- Digital touch controls
- 9 extraction speeds
- Silent brushless motor
- Perimeter aspiration
- Maximum extraction level 523m³/h
- Noise level 36-62dB
- 2 Cool white LED hob lights
- Delayed shut off timer
- Metal grease filter (dishwasher safe)
- For use with gas, ceramic and induction hobs
- Unbranded to match any kitchen

Dimensions (MM)

- Overall: H745-1090 x W595 x D385
- Ducting Diameter: 150
- Ducting kit accessory for external extraction: Code KITVENT2
- Filter kit for internal recirculation: Code TMFILT4



2 years
parts & labour



For technical information see page 78

90cm Ceiling Hood



CHC900WH

White glass



Hood Features

- Digital touch controls
- Remote control
- 3 extraction speeds
- Perimeter aspiration
- Maximum extraction level 618m³/h
- Noise level 57-68dB
- 2 cool white LED strip lights
- Delayed shut off timer
- 2 metal grease filters (dishwasher safe)
- For use with gas, ceramic and induction hobs
- Unbranded to match any kitchen

Dimensions (MM)

- Built-in aperture: H320 x W870 x D470
- Ducting Diameter: 150
- Ducting kit accessory for external extraction: Code KITVENT2
- Filter kit for internal recirculation: Code SCF1



2 years
parts & labour



For technical information see page 79

75cm Integrated Canopy Hood

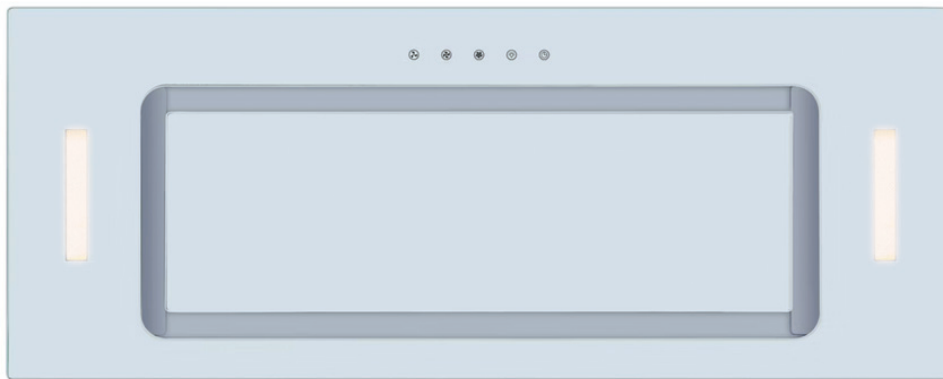

CHiC750WH

White glass



Hood Features

- Digital touch controls
- 3 extraction speeds
- Perimeter aspiration
- Maximum extraction level 593m³/h
- Noise level 63-69dB
- 2 cool white LED strip lights
- Delayed shut off timer
- Metal grease filter (dishwasher safe)
- For use with gas, ceramic and induction hobs
- Unbranded to match any kitchen

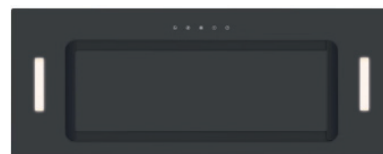

CHiC750BK
Black glass

Dimensions (MM)

- Built-in aperture: H307 x W730 x D275
- Ducting Diameter: 150
- Ducting kit accessory for external extraction: Code KITVENT2
- Filter kit for internal recirculation: Code ATFILT1



2 years
parts & labour



For technical information see page 79

52cm Integrated Canopy Hood

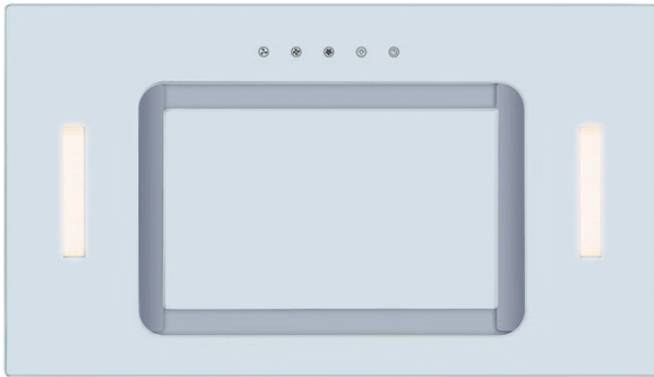

CHI520WH

White glass



Hood Features

- Digital touch controls
- 3 extraction speeds
- Perimeter aspiration
- Maximum extraction level 593m³/h
- Noise level 63-69dB
- 2 cool white LED strip lights
- Delayed shut off timer
- Metal grease filter (dishwasher safe)
- For use with gas, ceramic and induction hobs
- Unbranded to match any kitchen



CHI520BK
Black glass

Dimensions (MM)

- Built-in aperture: H307 x W50 x D275
- Ducting Diameter: 150
- Ducting kit accessory for external extraction: Code KITVENT2
- Filter kit for internal recirculation: Code ATFILT1



2 years
parts & labour

For technical information see page 79

90cm Glass Canopy Hood



CHCH920X

Stainless Steel with black fascia



Hood Features

- Digital touch controls
- 6 extraction speeds (including booster)
- Maximum extraction level 530m³/h
- Noise level 36-67dB
- Cool white LED hob strip light
- Delayed shut off timer
- Metal grease filter (dishwasher safe)
- For use with gas, ceramic and induction hobs
- Unbranded to match any kitchen

Dimensions (MM)

- Overall: H525-906 x W898 x D470
- Ducting Diameter: 150
- Ducting kit accessory for external extraction: Code KITVENT2
- Filter kit for internal recirculation: Code CARBFILT4



2 years
parts & labour



For technical information see page 79

60cm Glass Canopy Hood



CHCH620X

Stainless Steel with black fascia



Hood Features

- Digital touch controls
- 6 extraction speeds (including booster)
- Maximum extraction level 530m³/h
- Noise level 36-67dB
- Cool white LED hob strip light
- Delayed shut off timer
- Metal grease filter (dishwasher safe)
- For use with gas, ceramic and induction hobs
- Unbranded to match any kitchen

Dimensions (MM)

- Overall: H527-906 x W598 x D470
- Ducting Diameter: 150
- Ducting kit accessory for external extraction: Code KITVENT2
- Filter kit for internal recirculation: Code CARBFILT4



2 years
parts & labour



For technical information see page 79

90cm Chimney Hood



CHCH900X

Stainless Steel



Hood Features

- Push controls
- 3 extraction speeds
- Maximum extraction level 345m³/h
- Noise level 60-63dB
- 2 LED hob lights
- Metal grease filters (dishwasher safe)
- For use with gas, ceramic and induction hobs
- Unbranded to match any kitchen



CHCH900BK

Black

Dimensions (MM)

- Built-in aperture: H580-960 x W898 x D465
- Ducting Diameter: 150
- Ducting kit accessory for external extraction: Code KITVENT2
- Filter kit for internal recirculation: Code SCF2



2 years
parts & labour



For technical information see page 79

60cm Chimney Hood



CHCH600X

Stainless Steel



Hood Features

- Push controls
- 3 extraction speeds
- Maximum extraction level 345m³/h
- Noise level 60-63dB
- 2 LED hob lights
- Metal grease filters (dishwasher safe)
- For use with gas, ceramic and induction hobs
- Unbranded to match any kitchen



CHCH600BK

Black

Dimensions (MM)

- Built-in aperture: H580-960 x W598 x D465
- Ducting Diameter: 150
- Ducting kit accessory for external extraction: Code KITVENT2
- Filter kit for internal recirculation: Code SCF2



2 years
parts & labour



For technical information see page 79



Integrated cooling

Side by Side. The Tall larder fridge and freezer make a perfect pair sited side by side. This configuration provides optimum food preservation capacity in your kitchen – 25% more storage than the average American fridge freezer

Digital controls with temperature display allow you to control and monitor the appliance to a precise temperature, ensuring the foods and liquids are preserved at the perfect level.



Wooden shelves in Cata wine fridges provide an attractive feature. However, they also play an important role in eliminating vibration, which disturbs the sediment in the wine affecting flavour. Unlike metal shelves, wood will not scratch the wine labels.



Glass shelves in refrigerators help maintain high hygiene standards within the fridge, as well as being easier to clean. The shelves are made with safety glass and can be cleaned in a dishwasher. Fridge and freezer drawers are transparent, so you can check on the food with limited impact to the surrounding temperature.



The frost free feature eliminates the need for defrosting. The even distribution of cold air prevents frost forming inside the appliance on both the inner parts and on foodstuffs, so the appliance is not only easier to maintain, it is also easier to read the food labels.



The booster provides a fast cooling function, bringing the appliance to optimum temperature in the shortest possible time to ensure best the preservation of foodstuffs.



Dynamic fan cooling provides superior freshness throughout the refrigerator. The fan ventilation system uses pulsed air constantly diffused within the cavity. Therefore the same temperature is maintained throughout, guaranteeing optimal preservation of foodstuff irrespective of which shelf is used.



Cata offers a complete range of quiet appliances. Cooling appliances can operate at noise levels as low as **39 dB** – quieter than a library.

30cm Wine Cooler



CFW300GM

Gunmetal Glass

CFW300X

Stainless Steel

Features

- Digital touch controls with temperature display
- 6 Removable wooden shelves
- Cool white LED lighting
- Temperature range 5°C – 22°C
- Active charcoal filter
- UV protected glass
- Automatic defrost
- Unbranded to match any kitchen

Volume

- 20 bottle capacity
- Fridge: 58 litres

Dimensions (MM)

- Overall: H820-870 x W295 x D571
- Built-in aperture:
H822-872 x W300 x D550
- Recessed for fitting furniture plinth
- Reversible door
- Adjustable feet



2 years
parts & labour



For technical information see page 84

15cm Wine Cooler



Features

- Digital touch controls with temperature display
- 6 Removable wooden shelves
- Cool white LED lighting
- Temperature range 5°C – 22°C
- Active charcoal filter
- UV protected glass
- Automatic defrost
- Unbranded to match any kitchen

Volume

- 7 bottle capacity
- Fridge: 20 litres

Dimensions (MM)

- Overall: H843-870 x W146 x D522
- Built-in aperture: H845-872 x W150 x D550
- Recessed for fitting furniture plinth
- Reversible door
- Adjustable feet

CFW150BK

Black



CFW150GM

Gunmetal Glass



2 years
parts & labour



For technical information see page 84

70/30 Frost Free Fridge Freezer



CFF7030



Features

- Dynamic fan cooling for superior freshness
- Cool white LED lighting
- Fast freeze booster
- 3 adjustable glass safety shelves
- Salad crisper with cover & humidity control
- 4 adjustable door balconies
- 1 egg tray

Freezer Features

- 2 Freezer drawers
- 1 freezer compartment
- 1 ice cube tray
- Unbranded to match any kitchen

Volume

- Fridge: 181 litres
- Freezer: 75 litres

Dimensions (MM)

- Overall: H1770 x W540 x D545
- Built-in aperture: H1775 x W560 x D550
- Slider door fixing
- Reversible doors



5 years
parts & labour



For technical information see page 84

50/50 Frost Free Fridge Freezer



CFF5050



Features

- Dynamic fan cooling for superior freshness
- Cool white LED lighting
- Fast freeze booster
- 3 adjustable glass safety shelves
- Salad crisper with cover & humidity control
- 3 adjustable door balconies
- 1 egg tray

Freezer Features

- 3 Freezer drawers
- 1 freezer compartment
- 1 ice cube tray
- Unbranded to match any kitchen

Volume

- Fridge: 148 litres
- Freezer: 101 litres

Dimensions (MM)

- Overall: H1770 x W540 x D545
- Built-in aperture: H1775 x W560 x D550
- Slider door fixing
- Reversible doors



5 years
parts & labour



For technical information see page 84

Tall Larder Fridge



Fridge Features

- Dynamic fan cooling for superior freshness
- Electronic temperature control
- Temperature alarm
- Super cooling booster
- Cool white LED lighting
- 4 adjustable glass safety shelves
- 2 Salad crisper drawers with cover & humidity control
- 4 adjustable door balconies
- 1 egg tray
- Unbranded to match any kitchen

Volume

- Fridge: 303 litres

Dimensions (MM)

- Overall: H1770 x W540 x D545
- Built-in aperture: H1775 x W560 x D560
- Slider door fixing
- Reversible door

CFL1770



5 years
parts & labour

For technical information see page 84

Tall Larder Frost Free Freezer



Freezer Features

- Electronic temperature control with digital display
- Temperature alarm
- Economy / Holiday mode
- Super freeze booster
- 7 Freezer drawers
- 1 freezer compartment
- 1 ice cube tray
- Unbranded to match any kitchen

Volume

- Freezer: 221 litres

Dimensions (MM)

- Overall: H1770 x W540 x D545
- Built-in aperture: H1775 x W560 x D560
- Slider door fixing
- Reversible door

CFR1770



5 years
parts & labour

For technical information see page 84

Undercounter Fridge



CFU818



Fridge Features

- Cool white LED lighting
- 2 adjustable glass safety shelves
- Salad compartment
- 2 adjustable door balconies
- 1 egg tray
- Unbranded to match any kitchen

Volume

- Fridge: 136 litres

Dimensions (MM)

- Overall: H812-882 x W595 x D548
- Built-in aperture: H820-890 x W600 x D550
- Slider door fixing
- Reversible door
- Adjustable feet



2 years
parts & labour



For technical information see page 84

Undercounter Freezer



CFR818



Freezer Features

- 3 Freezer drawers
- 1 ice cube tray
- Unbranded to match any kitchen

Volume

- Freezer: 107 litres

Dimensions (MM)

- Overall: H812-882 x W595 x D548
- Built-in aperture: H820-890 x W600 x D550
- Slider door fixing
- Reversible door
- Adjustable feet



2 years
parts & labour



For technical information see page 84



Washing

With two high capacity models, both the washer and washer dryer offer a wide choice of programmes providing total flexibility to suit any family's needs. The Cata laundry appliances inspire all round confidence in performance and washing satisfaction.

The Cata Washer dryer boasts an 8kg capacity – that is 10 bath sheets in a single wash. Ideal for busy families.

No longer just a luxury appliance, the dishwasher has become a necessity for every kitchen. More hygienic than washing by hand, the Cata dishwasher saves water, energy and time.

The simple easy to use programmes use as little as 11 litres of water per cycle. Cata dishwashers deliver superior quality, a robust finish with excellent cleaning performance.

The versatile cutlery holder, foldable plate racks and adjustable upper basket means that the Cata dishwasher can accommodate up to 12 place settings, meaning you load and wash less saving time, water and energy.



Washing Machine Programmes



Cotton: Hard-wearing textiles, heat-resistant textiles made of cotton or linen.



Baby Care: A wash programme specific for baby clothes, which delivers a cleaner wash and longer rinse to better protect the baby's skin.



Jeans: A 1.45hr 40° wash with prewash, specifically for jeans



Mixed: A 1.20hr 40° wash with prewash, for mixed cotton and synthetics



Sports: A 1.11hr intensive 40°/60° wash with prewash, for active wear



Quick: A 15 minute cold wash for lightly soiled clothes.



Wool: For hand or machine washable wool or wool rich textiles. Especially gentle wash programme to prevent shrinkage, with longer programme pauses to soak the clothes.



ECO 40: A long, low temperature 3.35 wash, ideal for maintaining the colours on brighter clothing.



Intensive: A long 3.48hr, 40° wash for hard-wearing textiles, heat-resistant textiles made of cotton or linen.



Delicates: A gentle wash for silk, satin and blended fibres.



Synthetic: A long 40° wash for articles such as whites, shirts, trousers and coats.



Rapid 45°C: A 40° 45 minute quick wash for lightly soiled clothes.



20°C: A low temperature wash for non colourfast clothes.



The **Delayed start** allows you to set your wash to start at a time that is the most convenient and efficient for you.



The **Child lock** can be activated on the washing machines and washer dryers to prevent accidental tempering. Just hold down two keys for a few seconds to provide an extra level of safety for your family.



The **pause function** will pause the wash cycle. Great if you need to add an item after the wash programme has started.

7kg Washing Machine



CWM620



Features

- Electronic controls with digital display
- Delayed start
- Child lock
- Pause function
- Memory function
- Digital temperature control 20°C to 90°C
- Unbranded to match any kitchen

15 Prpgrammes

- Cotton
- Baby care
- Jeans
- Mixed
- Sports
- Quick wash
- Wool
- Spin only
- Rinse & Spin
- ECO 40oC
- Intensive
- 20°C
- Rapid 45°C
- Delicate
- Synthetic

Capacity

- Washing: 7kg

Spin speed

- 400 to 1400 RPM

Dimensions (MM)

- Overall: H852 x W595 x D540
- Built-in aperture: H850 x W600 x D550
- Adjustable feet



2 years
parts & labour



For technical information see page 88

8kg Washer Dryer



CWD620



Features

- Electronic controls with digital display
- Delayed start
- Child lock
- Pause function
- Memory function
- 3 dry levels: Gentle/Normal/Extra dry
- Digital temperature control 20°C to 90°C
- Unbranded to match any kitchen

15 Prpgrammes

- Cotton
- Baby care
- Jeans
- Mixed
- Sports
- Quick wash
- Wool
- Spin only
- Rinse & Spin
- Dry only
- 1 hour wash & dry
- ECO 40°C
- Wash & dry
- Intensive
- 20°C

Capacity

- Washing: 8kg
- Drying: 6kg

Spin speed

- 400 to 1400 RPM

Dimensions (MM)

- Overall: H852 x W595 x D540
- Built-in aperture: H850 x W600 x D550
- Adjustable feet



2 years
parts & labour



For technical information see page 88

60cm Dishwasher



CDW600



Features

- Electronic push button controls
- Delayed start (3, 6, 9, 12 hours)
- Adjustable upper basket
- Half load economy setting
- Unbranded to match any kitchen

4 Programmes

- Intensive
- ECO
- 90 minute wash
- Rapid wash 30 minutes

Capacity

- 12 Place Settings

Dimensions (MM)

- Overall: H815 x W595 x D570
- Built-in aperture: H820 x W600 x D580
- Adjustable feet



2 years
parts & labour



For technical information see page 88



Intensive: For heavily soiled items such as pots and pans with dried on food



ECO: This is the standard program suitable for normally soiled loads, such as pots, plates and glasses.



90 minute wash: For lightly soiled crockery and glass



Rapid: A shorter wash for lightly soiled loads that do not need drying.



Delayed start allows you to set your wash to start 3, 6, 9 or 12 hours which ever is the most convenient and efficient for you.



Ovens

MODEL NUMBER	COE615	COE600	CPW141
Functions			
Fan cooking	■	■	
Conventional cooking	■	■	
Base heat	■	■	
Fan + base heat	■	■	
Fan assisted cooking	■	■	
Turbo grill	■	■	
Dual grill	■	■	
Single Grill	■		
Defrost	■	■	■
Keep Warm	■		■
Fermentation function	■		■
Bright oven light	■	■	
Display & Controls			
Controls	Touch	Retractable	Touch
Animated display	■		
Electronic clock	■	■	
Minute minder	■	■	■
Programmable timer	■	■	
Temperature indicator	■		
Digital temperature control	■		■
Pause function	■		
Equipment & accessories			
Chrome side racks	■		
Chrome wire shelves	2	2	
Full width grill pan	■	■	
Trivet	■	■	
Cleaning			
Removable door	■	■	
Removeable inner glass	■	■	
Easy clean enamel interior	■	■	
Safety Features			
Double glazed door	■	■	
Cooling fan	■	■	
Child lock	■		
Weights (kg) & Dimensions HxWxD (mm)			
Built-in aperture	600x560x540	600x560x570	145x560x550
Overall	595x595x550	595x595x575	141x595x561
Volume litres (gross/net)	65/58	77/70	22
Packed	637x630x570	670x648x688	210x705x640
Net weight	33	31.5	18
Gross weight	31	35	21
Electrical Connection			
Cable	■	■	■
Connected load (kW)	2.9	2.9	1.0
Connection	220-240/50Hz	220-240/50Hz	220-240/50Hz
Fuse rating (amps)	13	13	13

MODEL NUMBER	COM450	CMG376
Functions		
Fan Cooking	■	
Microwave & Base heat	■	
Fan + Base heat	■	
Microwave & Fan	■	
Turbo Grill	■	
Dual grill	■	■
Defrost	■	■
Microwave	■	■
Microwave & Grill	■	■
Fan, Microwave & Grill	■	
Speedcook		■
Weight & power settings	■	■
Display & Controls		
Controls	Touch & Retractable	Touch & Rotary
Animated display	■	
Electronic clock	■	■
Minute minder	■	■
Programmable timer	■	
Pause function	■	
Equipment & accessories		
Chrome wire grill rack	■	■
Chrome wire roasting rack	■	
Glass turn table	■	■
Safety Features		
Double glazed door	■	
Cooling fan	■	
Child lock	■	■
Weights (kg) & Dimensions HxWxD (mm)		
Built-in aperture	450x560x550	365x566x315
Overall	454x595x568	376x592x315
Volume litres (gross/net)	47/44	22/20
Packed	550x700x670	468x706x403
Net weight	36	12.5
Gross weight	40	13.5
Electrical Connection		
Cabel	■	■
Connected load (kW)	3.4	1.1
Connection	230-240/50Hz	230/50Hz
Fuse rating (amps)	15	13

COE615 and COE600

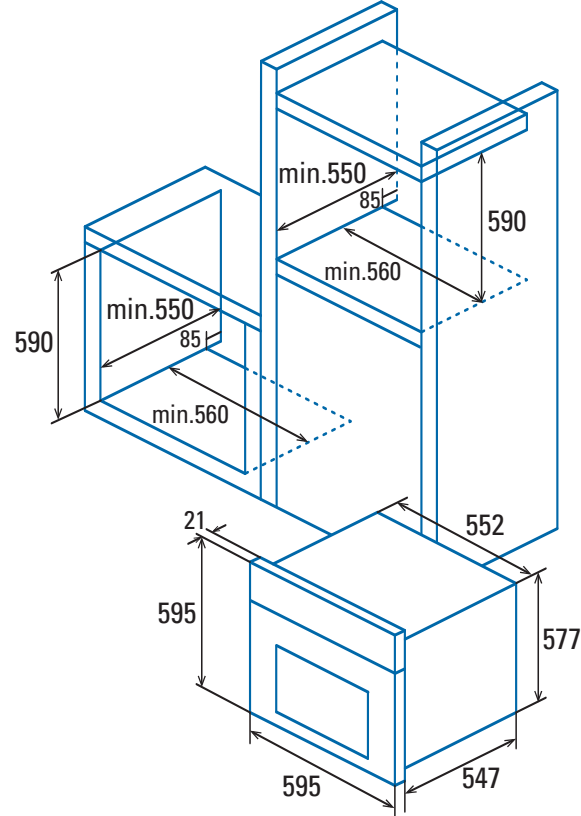

CPW141

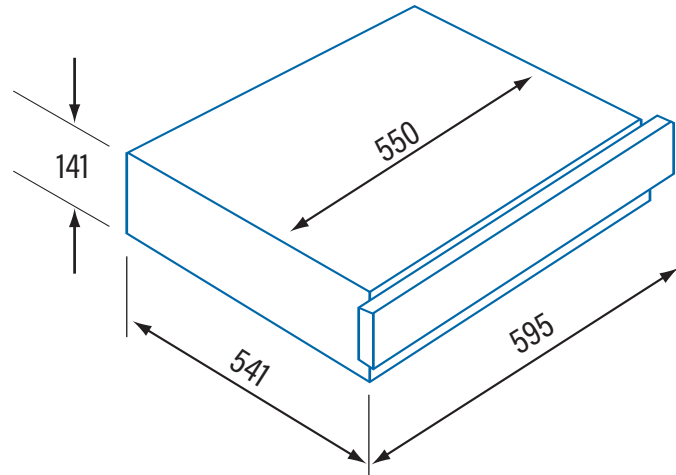

COM450

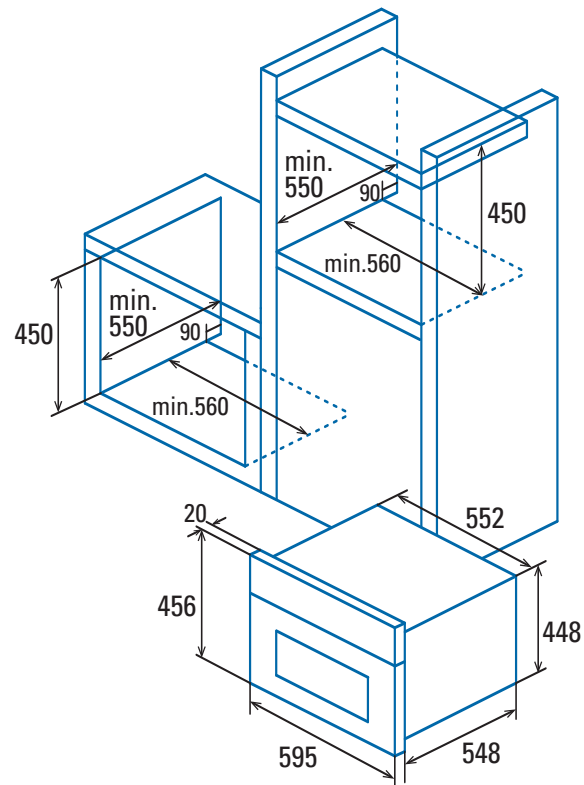

CMG450

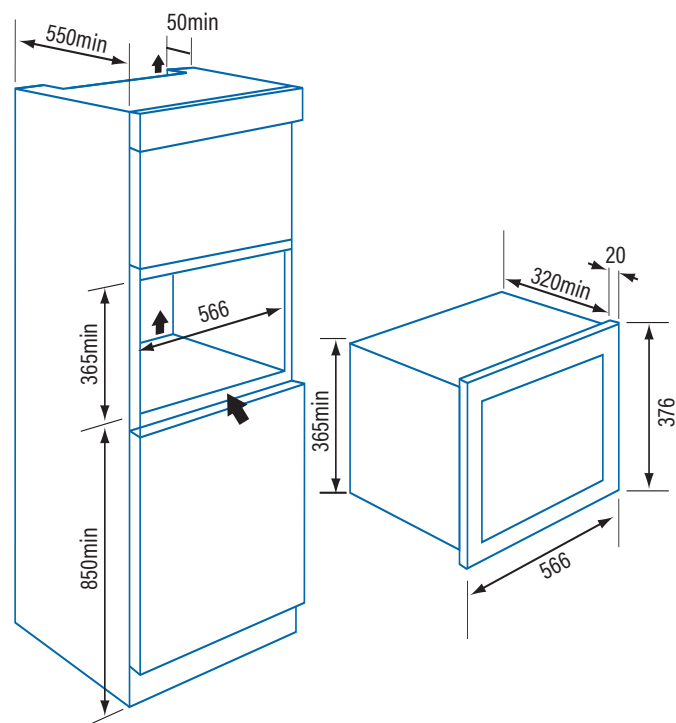

➡ airflow

Adequate ventilation must be allowed at the back and base of this unit

Hobs

MODEL NUMBER	CIDZ770F	CIHZ940F	CIHZ910F	CIHZ905F	CIHZ640F	CIHZ610F	CIH600F
Zone Specifications (mm & kW)							
Induction	4	5	5	4	4	4	4
Flex	2	2	2	2	2	2	-
Front right power	2.8kW	2.8kW	2.8kW	2.8kW	2.8kW	2.8kW	1.2kW
Front right size	190x190	190x190	190x190	190x190	190x190	190x190	155
Rear right power	2.0	2.0	2.0	2.0	2.0	2.0	1.8
Rear right size	190x190	190x190	190x190	190x190	190x190	190x190	190
Front left power	2.8kW	2.8kW	2.8kW	2.8kW	2.8kW	2.8kW	2
Front left size	190x190	190x190	190x190	190x190	190x190	190x190	190
Rear left power	2.0	2.0	2.0	2.0	2.0	2.0	1.2
Rear left size	190x190	190x190	190x190	190x190	190x190	190x190	155
Centre power		3.0	3.0				
Centre size		280	280				
Hob Features							
Controls	Touch	TFT	Touch	Touch	TFT	Touch	Touch
Displays	Red LED	Full colour	Red LED	Red LED	Full colour	Red LED	Red LED
Programmable timer	■	■	■	■	■	■	■
Minute minder	■	■	■	■	■	■	■
Power levels	12	11	12	14	11	12	11
Booster(s)	■	■	■	■	■	■	■
Pause function	■	■	■	■	■	■	■
Keep warm function	■		■	■		■	■
Hob to hood control		■		■	■		
Safety Features							
Auto safety shut off	■	■	■	■	■	■	■
Child lock	■	■	■	■	■	■	■
Anti over heat	■	■	■	■	■	■	■
Anti over flow	■	■	■	■	■	■	■
Automatic pan detection	■	■	■	■	■	■	■
Residual heat indicators	■	■	■	■	■	■	■
Small object detection	■	■	■	■	■	■	■
Control panel protection	■	■	■	■	■	■	■
Weights (kg) & Dimensions HxWxD (mm)							
Built-in aperture	300x750x490	65x875x495	56x875x495	56x875x325	65x565xD495	56x565x495	58x560x490
Overall	250x770x520	65x900x520	60x900x520	60x900x350	65x590x520	60x590x520	60x590x520
Packed	330x830x580	100x990x595	110x960x595	110x960x390	110x675x595	110x650x595	110x650x595
Net weight	18.3	14.9	14.9	12.5	8.5	8.5	8
Gross weight	21.0	17	17	14.5	9.7	9.7	9.5
Electrical Connection							
Cable	■	■	■	■	■	■	q
Connected load (kW)	7.4	9.0	9.0	7.2	7.2	2.8/7.2	2.8
Connection	220-240/50Hz	220-240/50Hz	220-240/50Hz	220-240/50Hz	220-240/50Hz	220-240/50Hz	220-240/50Hz
Fuse rating (amps)	32	40	40	32	32	13 or 32	13 or 32

MODEL NUMBER	CGH900	CGH700	CGH600
Zone Specifications (kW)			
Gas burners	5	5	4
Front right power	1.75	1.75	3.50
Front right type	semi-rapid	semi-rapid	wok
Rear right power	3.00	1.75	
Rear right type	rapid	semi-rapid	
Front left power	1.00	1.00	3.00
Front left type	auxiliary	auxiliary	rapid
Rear left power	1.75	3.00	
Rear left type	semi-rapid	rapid	
Centre power	3.50	3.50	1.75 / 1.0
Centre type	wok	wok	semi-rapid / aux
Hob Features			
Controls	Rotary	Rotary	Rotary
Control position	Front	Front	Front
Pan supports	Cast iron	Cast iron	Cast iron
Integrated ignition	■	■	■
LPG kit	■	■	■
Gas safety shut off	■	■	■
Weights (kg) & Dimensions HxWxD (mm)			
Built-in aperture	40x830x480	40x560x480	40x550x475
Overall	40x860x510	40x700x510	40x640x510
Packed	155x940x555	155x765x560	170x715x550
Net weight	170	16.5	10.5
Gross weight	18.5	17.6	11.5
Electrical Connection			
Cable	Yes	Yes	Yes
Gas Power	11.0kW	11.0kW	9.25kW
Connection	220-240/50Hz	220-240/50Hz	220-240/50Hz
Fuse rating (amps)	3	3	3

CIDZ770F

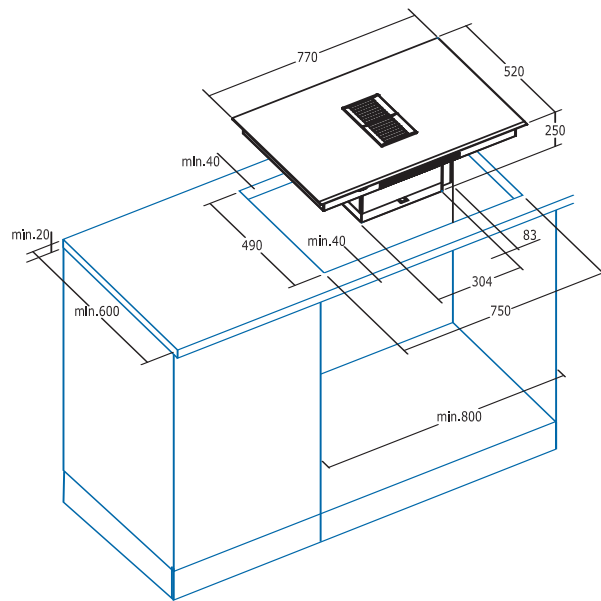
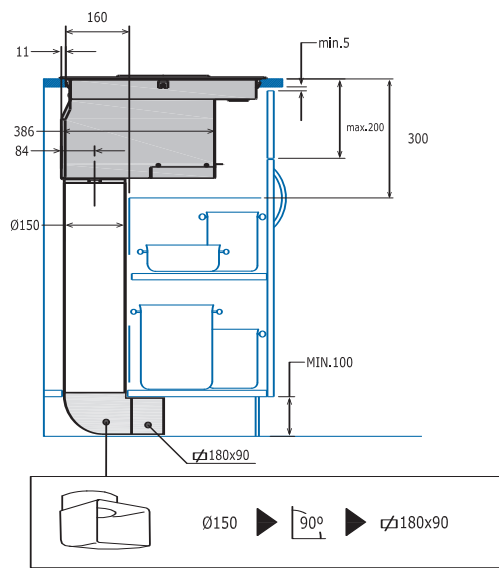

CIHZ910F and CIHZ940F

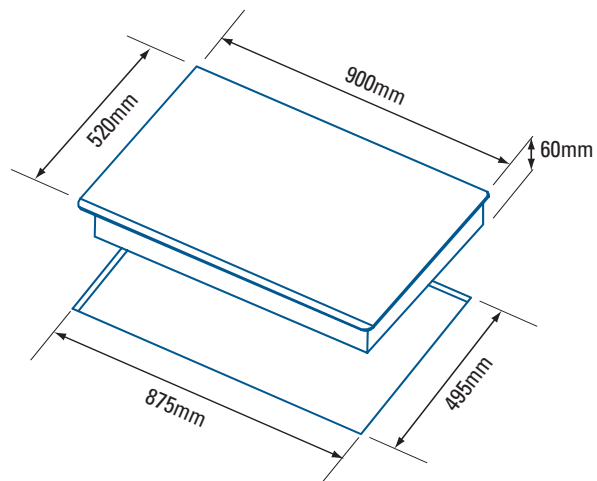

CIHZ905F

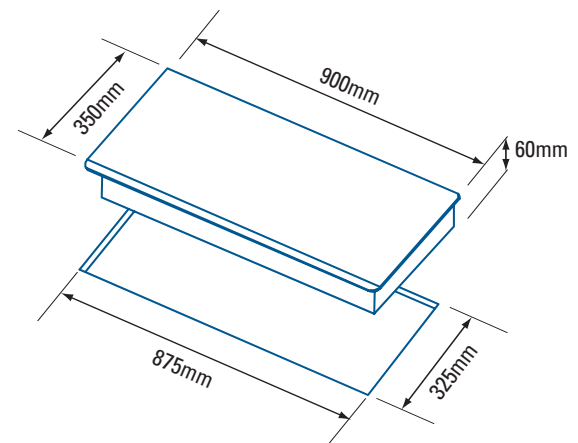

CIHZ600F, CIHZ610F and CIHZ640F

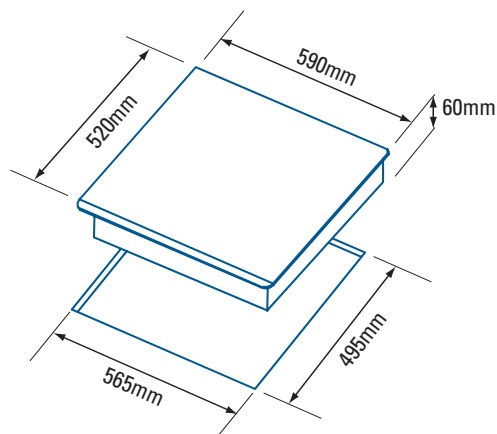

CGH900F

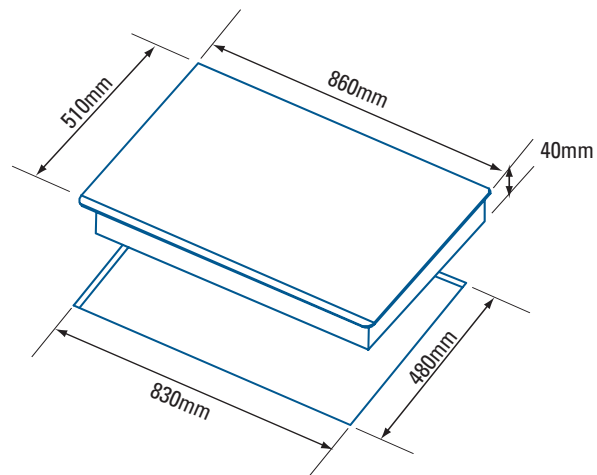

CGH700F

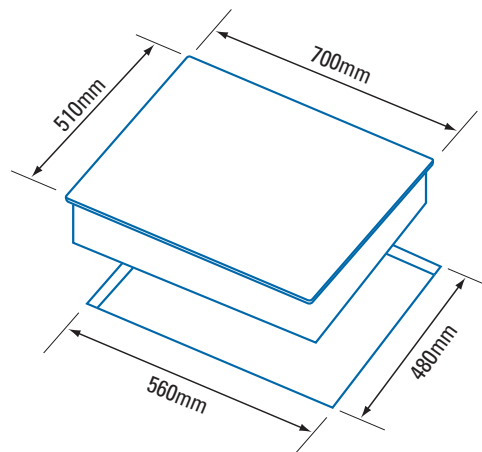

CGH600F

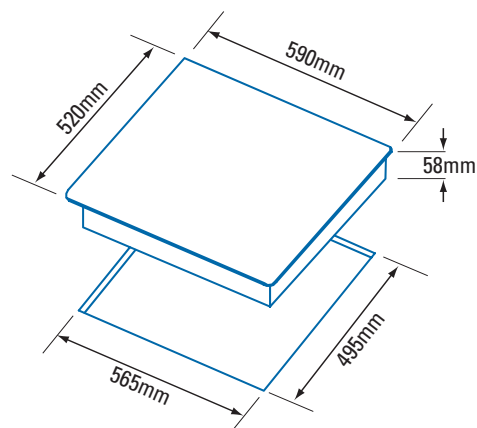

Hoods

MODEL NUMBER	CHD930	CHD630	CHW950	CHW850	CHW930	CHW730	CHW630	CHW900
Hood type	Downdraft	Downdraft	Wall	Wall	Wall	Wall	Wall	Wall
Performance								
Fan speeds	4	4	4	4	6	6	6	9
Extraction m3/h	590	590	850	850	575	575	575	523
Max noise dB	73	73	65	65	61	61	61	62
Min. noise dB	52	52	50	50	44	44	44	43
Perimeter aspiration	■	■	■	■	■	■	■	q
Hoods features								
Controls	Digital	Digital	Digital	Digital	Digital	Digital	Digital	Digital
Metal grease filters	■	■	■	■	■	■	■	■
Saturation indicator			■	■	■	■	■	
Lighting	LED	LED	LED	LED	LED	LED	LED	LED
Timer	■	■	■	■	■	■	■	■
Hob to hood control								
Installation & Dimensions HxWxD								
Built-in aperture (mm)	718x792x341	718x492x341						
Overall (mm)	718-1053x880x341	718-1053x580x341	755-1070x900x290	755-1070x800x290	845-1130x900x306	845-1130x700x306	845-1130x600x306	775-1090x895x358
Packed (mm)	805x965x490	805x665x490	500x940x450	500x840x450	500x940x450	478x732x390	485x635x380	500x940x450
Net weight (kg)	28.5	23.5	12.5	12.2	12.5	14.8	11	12.5
Gross weight (kg)	34.5	27.5	15.3	15	15.3	12	12.8	15.3
Ducting diameter (mm)	150	150	150	150	150	150	150	150
Distance from gas hobs (mm)	65	65	650	650	650	650	650	650
Distance from electric hobs (mm)	40	40	530	530	530	530	530	650
Distance from induction hobs (mm)	40	40	400	400	400	400	400	400
Accessories								
Carbon filter	ATFILT4	ATFILT3	2859398	2859398	2859394	2859394	2859394	TMFILT4
Ducting kit	KITVENT2	KITVENT2	KITVENT2	KITVENT2	KITVENT2	KITVENT2	KITVENT2	KITVENT2
Electrical Connection								
Cable	■	■	■	■	■	■	■	■
Connected load (kW)	0.23	0.23	0.13	0.13	0.14	0.14	0.14	0.073
Connection	220-240/50Hz	220-240/50Hz	220-240/50Hz	220-240/50Hz	220-240/50Hz	220-240/50Hz	220-240/50Hz	220-240/50Hz
Fuse rating (amps)	3	3	3	3	3	3	3	3

MODEL NUMBER	CHW600	CHC900	CHiC750	CHiC520	CHCH920	CHCH620	CHCH900	CHCH600
Hood type	Wall	Ceiling	Canopy	Canopy	Chimney	Chimney	Chimney	Chimney
Performance								
Fan speeds	9	3	3	3	6	6	3	3
Extraction m³/h	523	618	593	593	530	530	345	345
Max noise dB	62	68	69	69	67	67	63	63
Min. noise dB	36	57	63	63	36	36	60	60
Perimeter aspiration	■	■	■	■				
Hoods features								
Controls	Digital	Digital/Remote	Digital	Digital	Digital	Digital	Push	Push
Metal grease filters	■	■	■	■	■	■	■	■
Saturation indicator								
Lighting	LED	LED	LED	LED	LED	LED	LED	LED
Timer	■	■	■	■	■	■		
Hob to hood control					■	■		
Installation & Dimensions HxWxD								
Built-in aperture (mm)			320x870x470	307x724x270	307x500x270			
Overall (mm)	745-1090x595x3852	320x895x500	307x750x296	307x520x296	525-960x898x470	527-906x598x470	580-960x898x465	580-960x598x465
Packed (mm)	485x635x380	389x957x557	340x785x350	340x530x350	525x960x250	520x640x250	245x950x560	245x650x520
Net weight (kg)	11	21	10	6.5	11.5	8.5	9.0	7.0
Gross weight (kg)	12.8	25	12	7.5	13.7	10.5	10.0	8.5
Ducting diameter (mm)	150	150	150	150	150	150	150	150
Distance from gas hobs (mm)	650	750	750	750	750	750	750	750
Distance from electric hobs (mm)	650	650	650	650	650	650	650	650
Distance from induction hobs (mm)	400	400	400	400	400	400	400	400
Accessories								
Carbon filter	TMFILT4	SCF1	ATFILT1	ATFILT1	CARBFLT4	CARBFLT4	SCF2	SCF2
Ducting kit	KITVENT2	KITVENT2	KITVENT2	KITVENT2	KITVENT2	KITVENT2	KITVENT2	KITVENT2
Electrical Connection								
Cable	■	■	■	■	■	■	■	■
Connected load (kW)	0.073	0.24	0.19	0.19	0.093	0.093	0.069	0.069
Connection	220-240/50Hz	220-240/50Hz	220-240/50Hz	220-240/50Hz	220-240/50Hz	220-240/50Hz	220-240/50Hz	220-240/50Hz
Fuse rating (amps)	3	3	3	3	3	3	3	3

CHD930

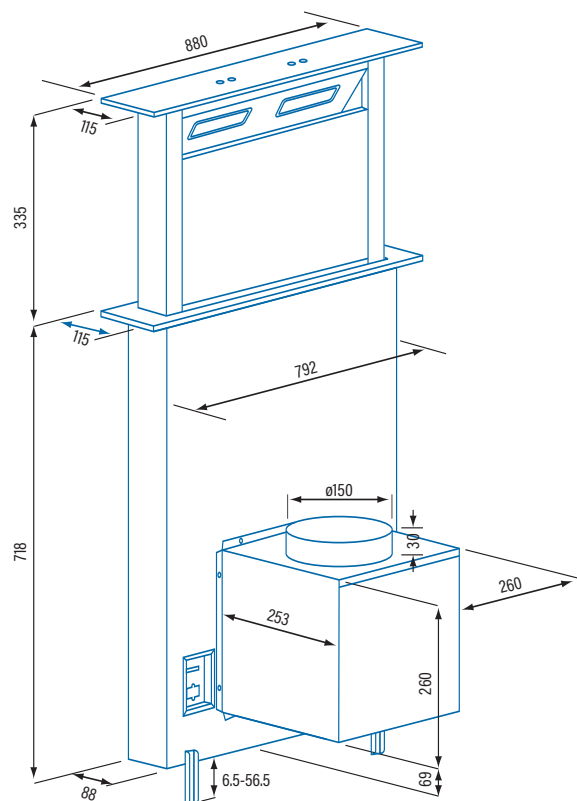

CHD630

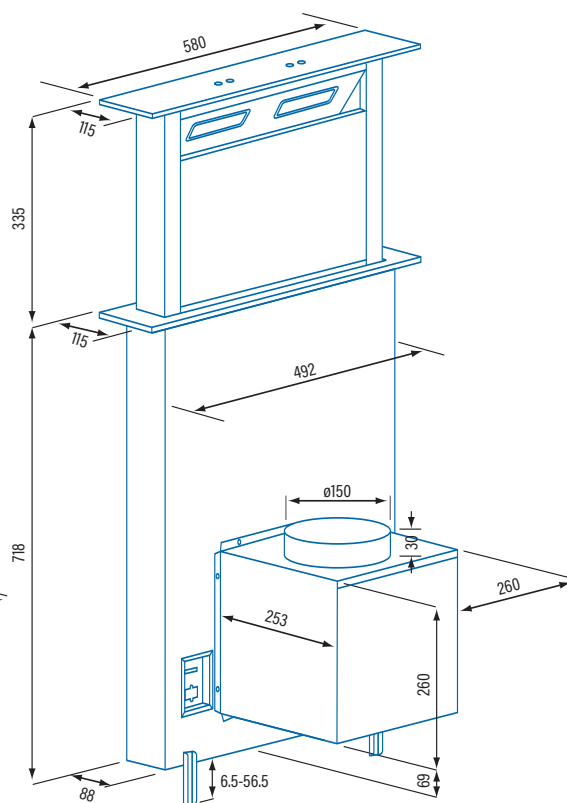

CHW950

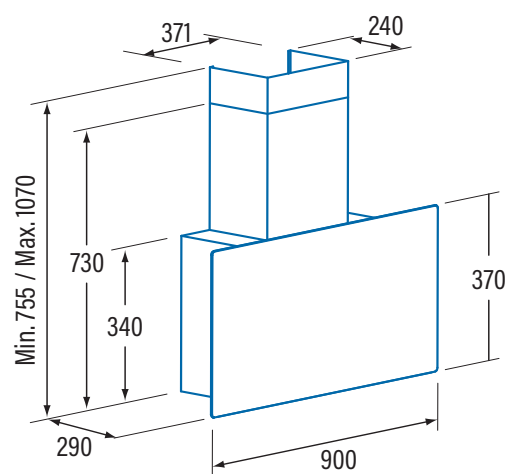

CHW850

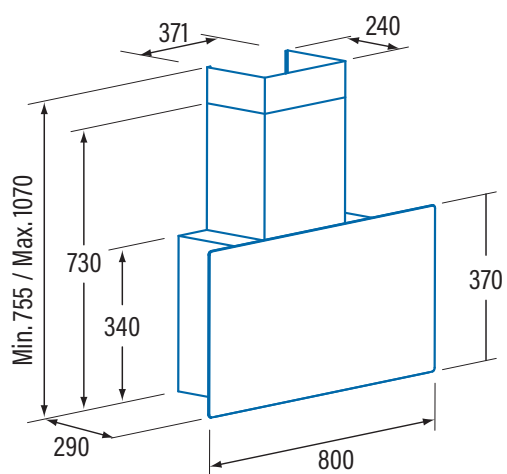

CHW930

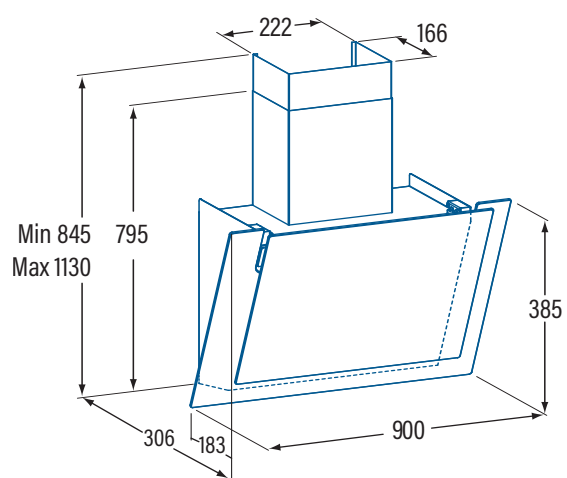

CHW730

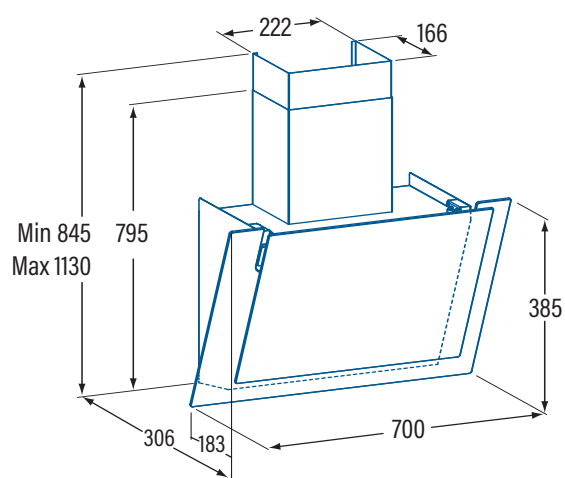

CHW630

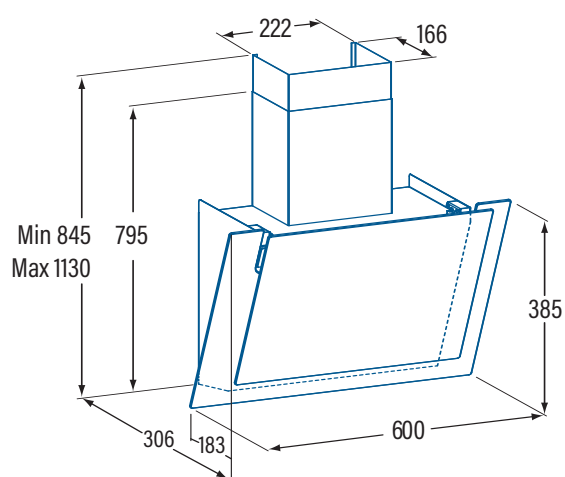

CHW900

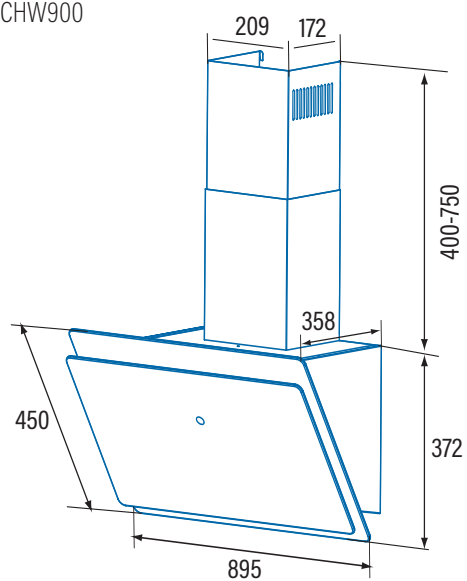

CHW600

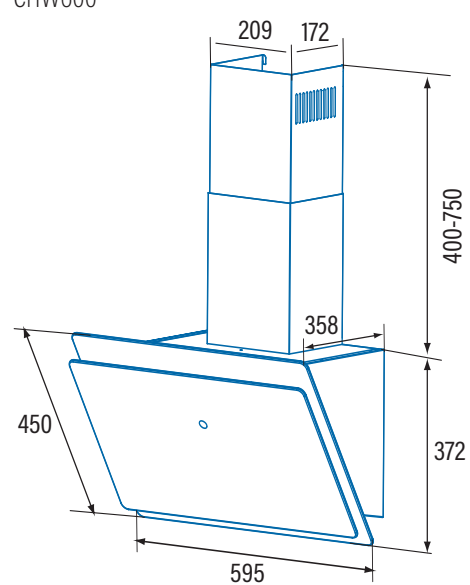

CHC900

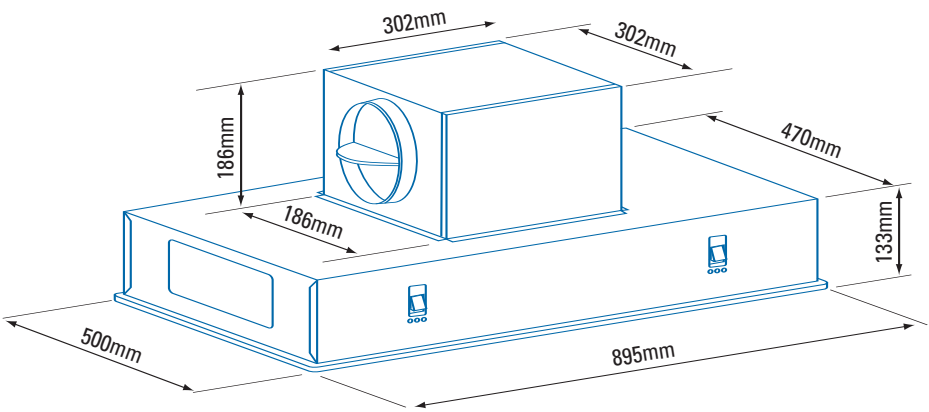

CHIC750

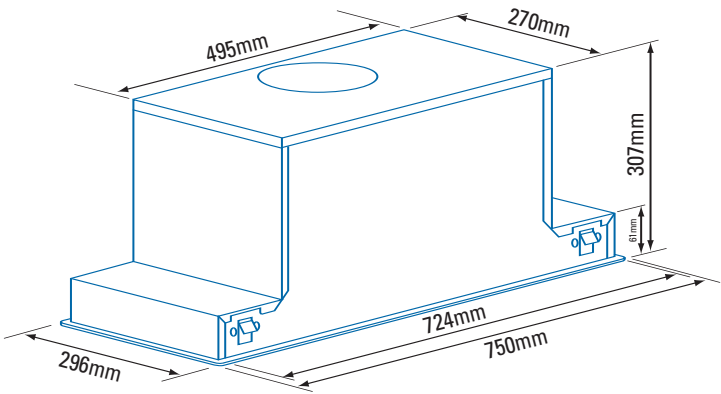

CHIC520

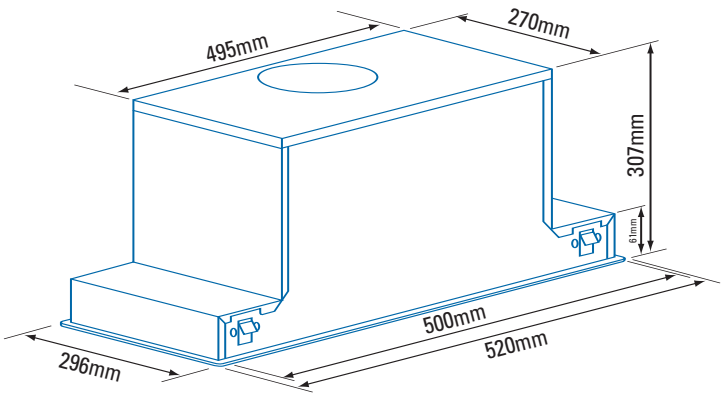

CHCH920

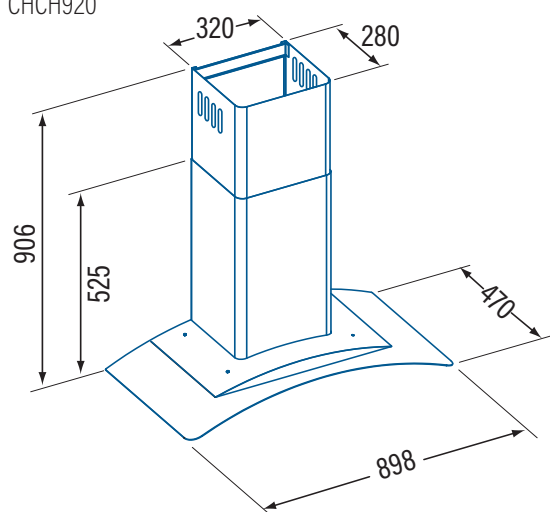

CHCH620

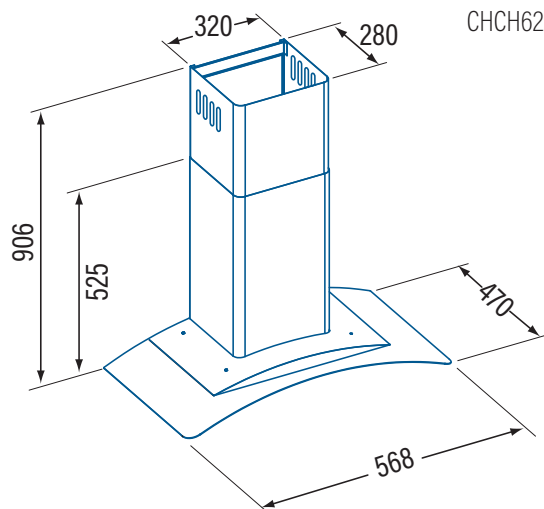

CHCH900

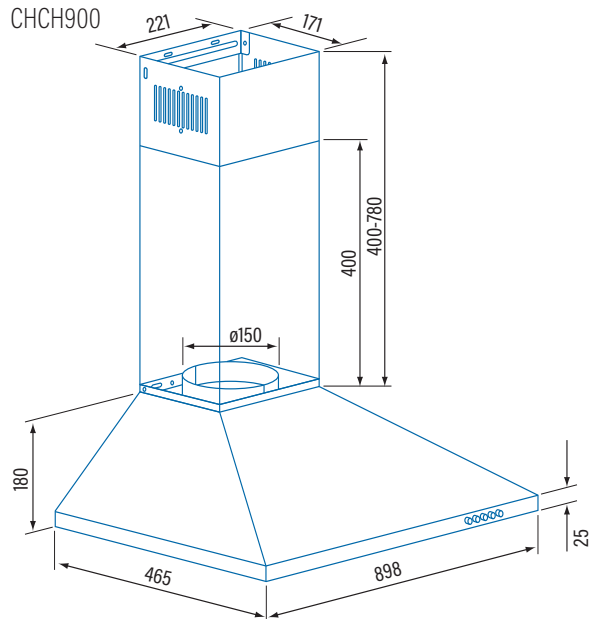

CHCH600

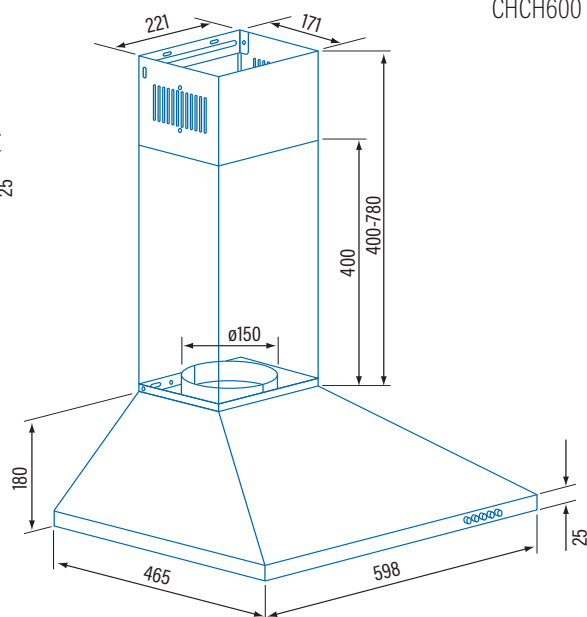

Cooling

MODEL NUMBER	CFW300	CFW150	CFF7030	CFF5050	CFL1770	CFR1770	CFU818	CFR818
Performance								
Shelves	6 Wooden	6 Wooden	3 glass	3 glass	4 glass		2	
Drawers			2	3	2	7		3
Balconies			4	3	4		2	
Egg tray			■	■	■		■	
Ice tray			■	■		■		■
Salad crisper			■	■	2			
Flexible shelf positions		■	■	■	■	■		■
Fan cooling	■	■	■	■	■			
Frost free	■	■	■	■		■		
LED lighting	■	■	■	■	■		■	
Fast freeze			■	■		■		
Digital temperture control		■	■			■	■	
Energy efficiency	F	F	F	F	F	F	F	F
Climate class	N/ST	N/ST	N/T	N/T	SN/T	SN/T	SN	SN
Rising time (hours)			12	13		9		18
Freezer Star rating			4	4		4		4
Noise level	42	39	41	41	39	40	39	39
Installation & Dimensions HxWxD								
Net volume	58	20	180/63	147/86	300	221	133	93
Gross volume	60	22	181/75	148/101	303	197	136	107
Built-in aperture (mm)	822-872x300x550	845-872x150x550	1775x560x550	1775x560x550	1775x560x560	1775x560x560	820-890x600x550	820-890x600x550
Overall (mm)	820-870x295x571	843-870x146x522	1770x540x545	1770x540x545	1770x540x545	1770x540x545	812-882x595x548	812-882x595x548
Packed (mm)	350x645x880	205x590x920	1834x584x577	1834x584x577	1834x584x577	1834x584x577	883x659x586	883x659x586
Net weight (kg)	28.6	21	72	72	70	70	35	33
Gross weight (kg)	34.6	24.5	75.5	75.5	73.5	73.5	37	35
Door fixing	-	-	Slider	Slider	Slider	Slider	door on door	door on door
Reversible door	■	■	■	■	■	■	■	■
Electrical Connection								
Cable & plug	■	■	■	■	■	■	■	■
Connected load (kW)	0.07	0.07	0.085	0.083	0.05	0.065	0.029	0.043
Connection	220-240/50Hz	220-240/50Hz	220-240/50Hz	220-240/50Hz	220-240/50Hz	220-240/50Hz	220-240/50Hz	220-240/50Hz
Fuse rating (amps)	13	13	13	13	13	13	13	13

CFW300

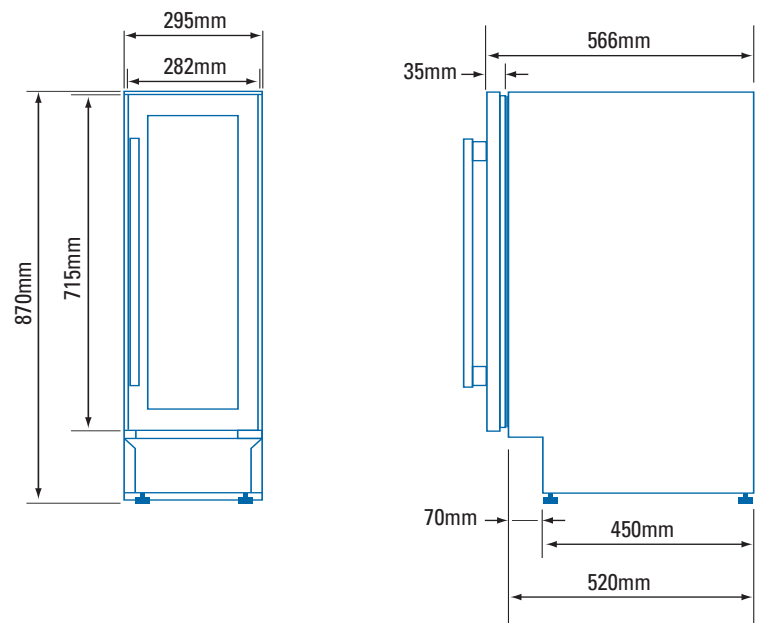

CFW150

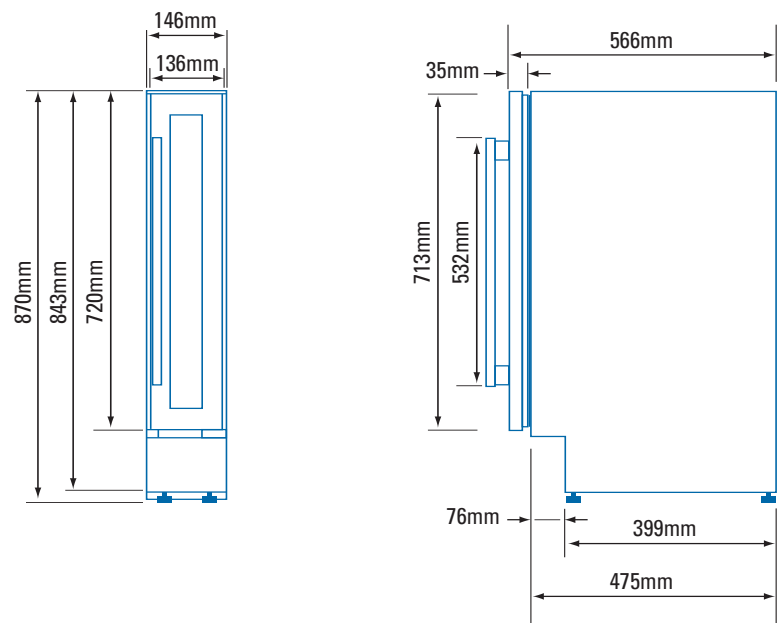

CFF7030

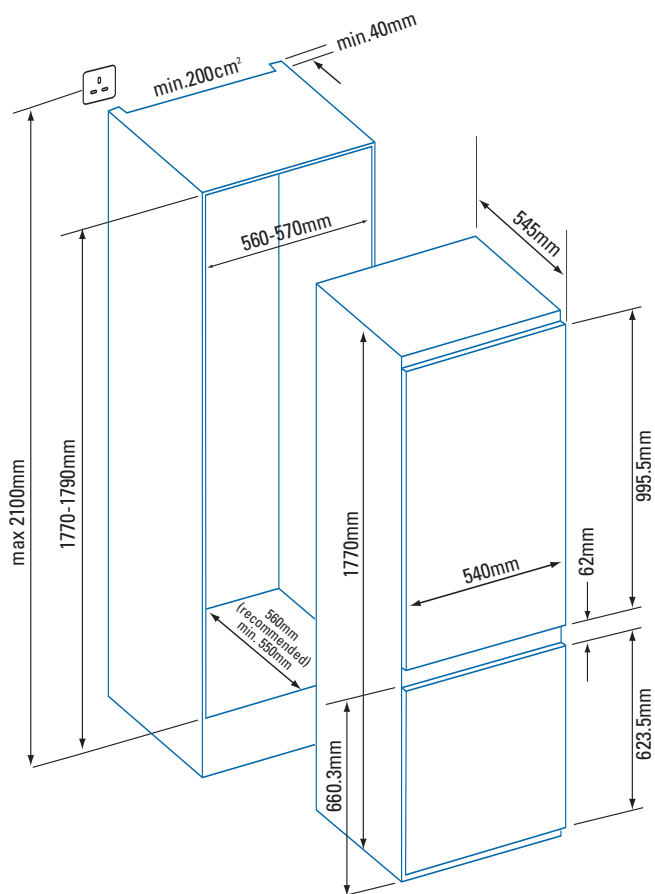

CFF5050

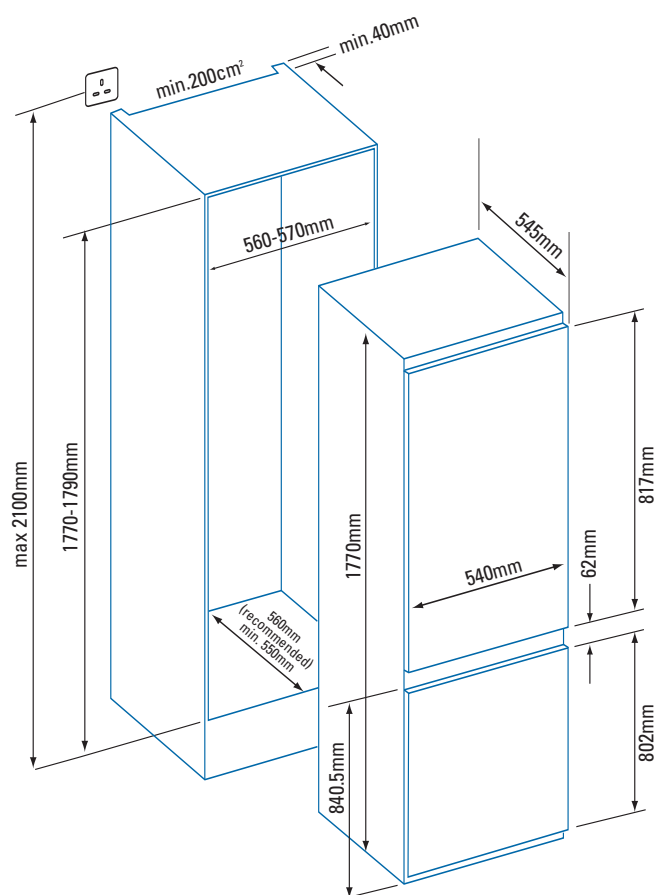

CFL1770 and CFR1770

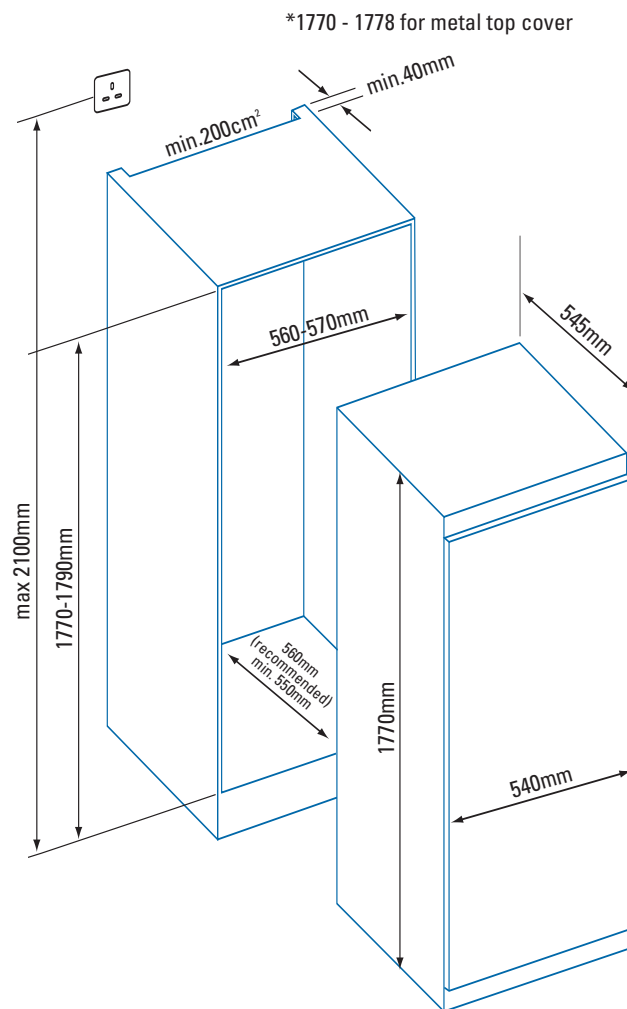

CFU818 and CFR818

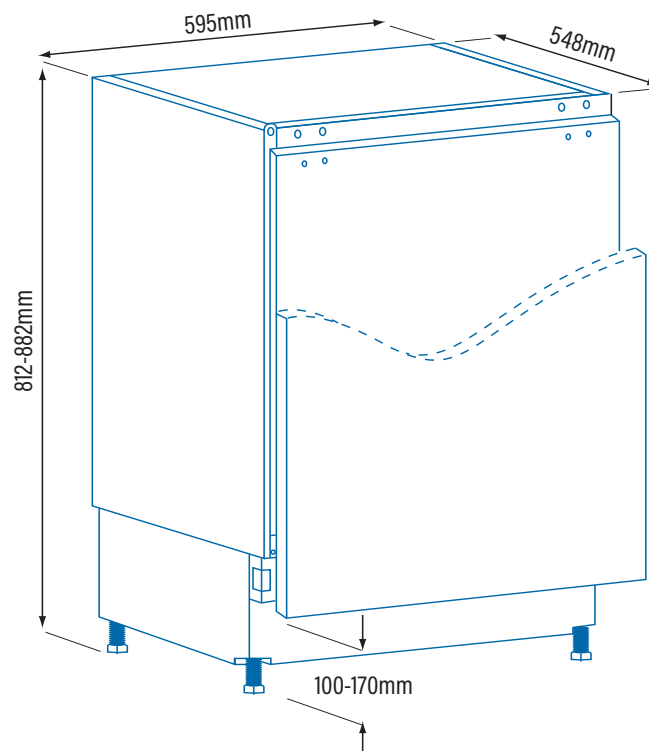

Washing

MODEL NUMBER	CWM620	CWD620
Performance		
Wash capacity (kg)	7	8
Dry capacity (kg)		6
Spin speed (RPM)	400-1400	400-1400
Temperature range °C	20-90	20-90
Controls		
Electronic controls	■	■
Digital display	■	■
Delay timer	■	■
Child lock	■	■
Memory function	■	■
Pause function	■	■
Digital temperature control	■	■
Number of programmes	15	15
Energy efficiency		
Energy class	A	A
Airborne acoustical noise spinning (dBA)	76	76
Water consumption per cycle (ltr)	48	48
Energy consumption per cycle (kWh)	0.545	0.545
Installation & Dimensions HxWxD		
Built-in aperture (mm)	852x600x550	852x600x550
Overall (mm)	850x595x540	850x595x540
Packed (mm)	865x610x555	865x610x555
Net weight (kg)	77	77
Gross weight (kg)	79.5	79.5
Adjustable feet	■	■
Electrical Connection		
Cable & plug	■	■
Connected load (kW)	1.95	1.95
Connection	220-240/50Hz	220-240/50Hz
Fuse rating (amps)	13	13

MODEL NUMBER	CDW600
Features	
Wash capacity (place settings)	12
Electronic controls	■
Delay timer	■
Number of programmes	4
End of programme signal	■
Half load	■
Interior	
Adjustable basket	■
Folding plate racks	■
Knife rack	■
Cutlery basket	■
Automatic detergent dispenser	■
Cleaning filter	■
Energy efficiency	
Energy class	F
Cleaning efficiency	A
Drying efficiency	A
Noise level (dBA)	49
Water consumption per cycle (ltr)	11
Energy consumption per cycle (kWh)	0.908
Installation & Dimensions HxWxD	
Built-in aperture (mm)	820x600x580
Overall (mm)	815x595x570
Packed (mm)	871x645x645
Net weight (kg)	66
Gross weight (kg)	68.5
Adjustable feet	■
Electrical Connection	
Cable & plug	■
Connected load (kW)	2.1
Connection	220-240/50Hz
Fuse rating (amps)	13

CWM620 and CWD620

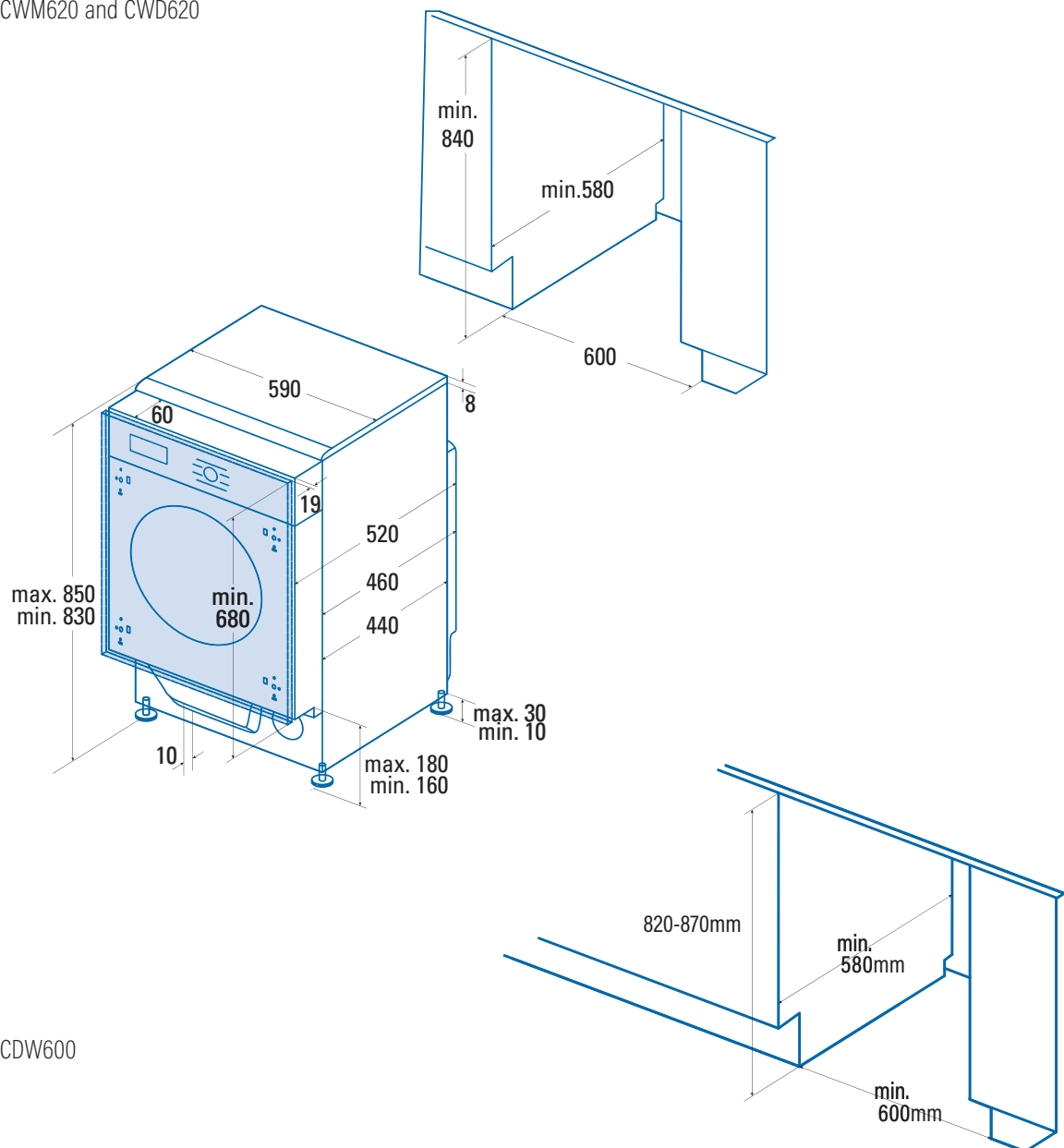

CDW600

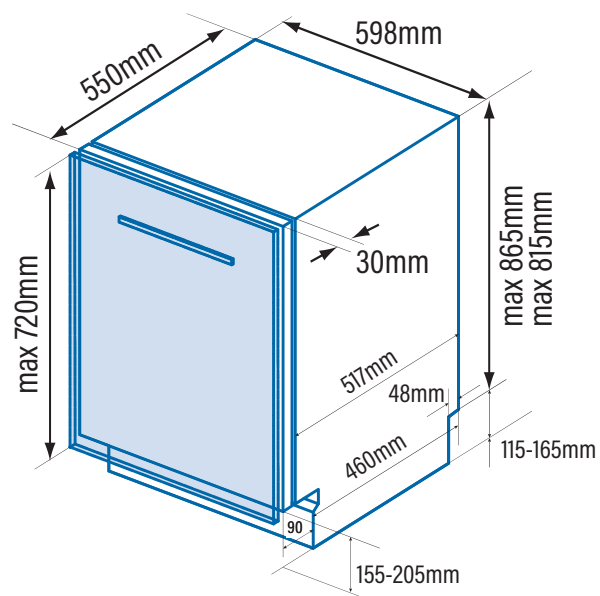



cata 

www.cataappliances.co.uk

Cata Appliances UK Ltd, Unit 3 Normandy Landings, Pope Street, Castleford, West Yorkshire WF6 2AG